

CODE A

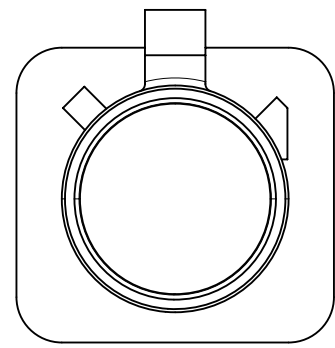

CODE B

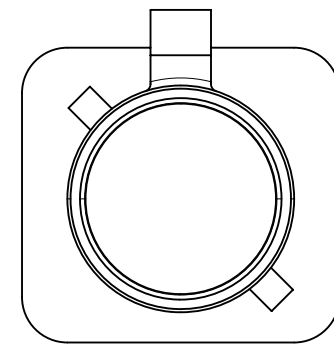

CODE C

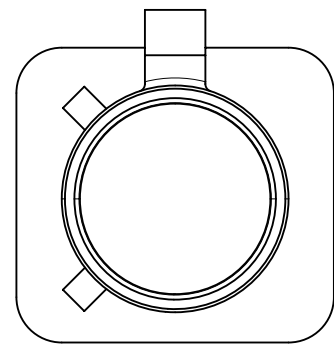

CODE D

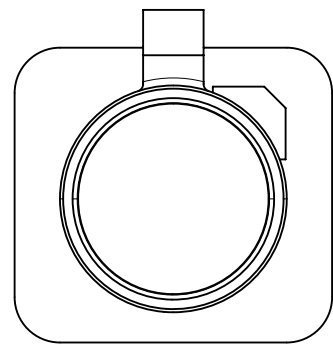

CODE E

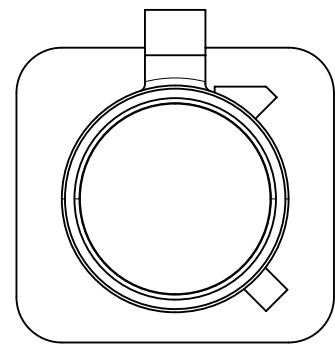

CODE F

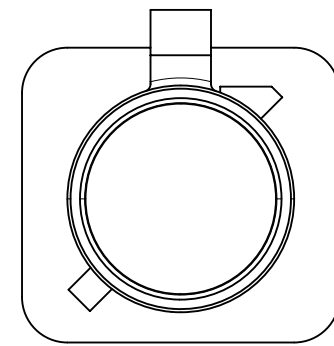

CODE G

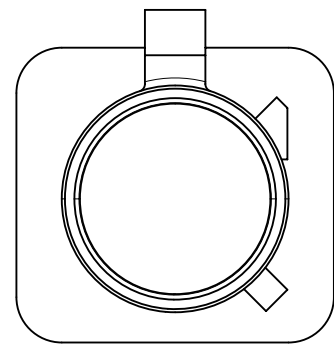

CODE H

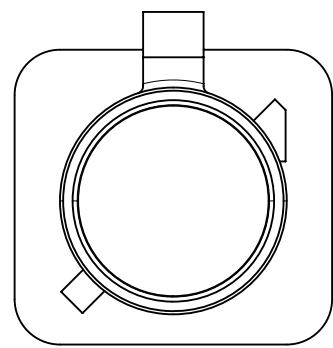

CODE I

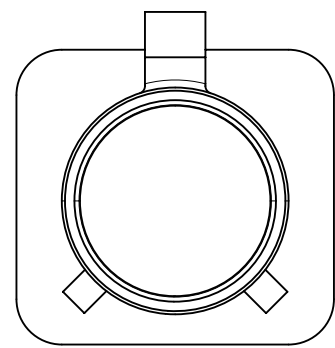

CODE K

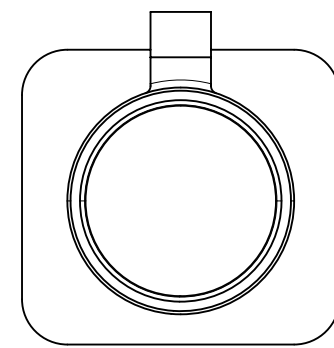

CODE Z

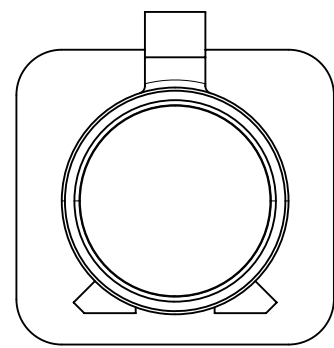

CODE L

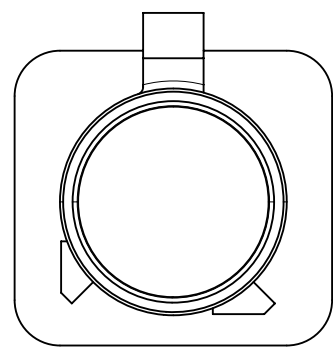

CODE M

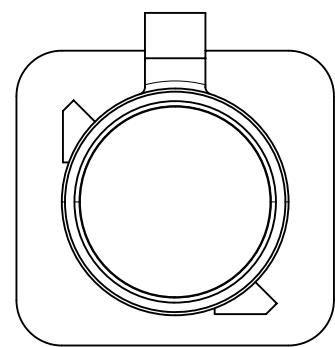

CODE N

|            |          |                 |
|------------|----------|-----------------|
| 89558-9203 | N        | PASTEL GREEN    |
| 89558-9202 | M        | PASTEL ORANGE   |
| 89558-9201 | L        | CARMINE RED     |
| 89558-9200 | Z        | WATER BLUE      |
| 89558-9199 | K        | CURRY YELLOW    |
| 89558-9198 | I        | BEIGE           |
| 89558-9197 | H        | VIOLET          |
| 89558-9196 | G        | GRAY            |
| 89558-9195 | F        | BROWN           |
| 89558-9194 | E        | GREEN           |
| 89558-9193 | D        | BORDEAUX VIOLET |
| 89558-9192 | C        | BLUE            |
| 89558-9191 | B        | CREAM WHITE     |
| 89558-9190 | A        | BLACK           |
| SHROUD NO. | KEY CODE | COLOR           |
|            |          |                 |

|  |   |                          |                                       |                        |                 |          |            |
|--|---|--------------------------|---------------------------------------|------------------------|-----------------|----------|------------|
| <b>QUALITY SYMBOLS</b><br>                           | THIS DRAWING CONTAINS INFORMATION THAT IS PROPRIETARY TO MOLEX ELECTRONIC TECHNOLOGIES, LLC AND SHOULD NOT BE USED WITHOUT WRITTEN PERMISSION |                          |                                       |                        |                 |          |            |
|  | EC NO: 122054<br>DRWN: BSHAH<br>CHKD:<br>REV / APPR: AROBERTSON   | 2017/09/07<br>2017/09/21 | GENERAL TOLERANCES (UNLESS SPECIFIED) |                        | DIMENSION UNITS | SCALE    |            |
|  |   |                          |                                       | MM                     | INCH            | METRIC   | NTS        |
|  |   |                          | 4 PLACES                              | ±                      | ±               | DRWN BY  | DATE       |
|  |   |                          | 3 PLACES                              | ±                      | ± 0.005         | LMEIER   | 2016/05/16 |
|  |   |                          | 2 PLACES                              | ± 0.13                 | ± 0.01          | CHK'D BY | DATE       |
|  | 1 PLACES  | ± 0.25                   | ±                                     | SSS                    | 2016/05/16      |          |            |
|  | 0 PLACES  | ±                        | ±                                     | APPR BY                | DATE            |          |            |
|  |   |                          |                                       | AROBERTSON             | 2016/07/12      |          |            |
|  | ANGULAR TOL = 2.0   |                          | DRAWING SIZE                          | THIRD ANGLE PROJECTION |                 |          |            |
| DRAFT WHERE APPLICABLE MUST REMAIN WITHIN DIMENSIONS |   | <b>C</b>                 |                                       |                        |                 |          |            |

|  |                 |          |              |
|--|-----------------|----------|--------------|
| <b>molex</b>   |                 |          |              |
| FAKRA JACK SEALED<br>RG58 7 MM CLIP SLOT FAKRA-JC, EWR-10016 |                 |          |              |
| PRODUCT CUSTOMER DRAWING                                     |                 |          |              |
| SERIES   | MATERIAL NUMBER | CUSTOMER |              |
| 73403  | SEE SHT'S 3 & 4 |          |              |
| DOCUMENT NUMBER  | DOC TYPE        | DOC PART | SHEET NUMBER |
| SD-73403-105   | PSD             | 001      | 2 OF 4       |



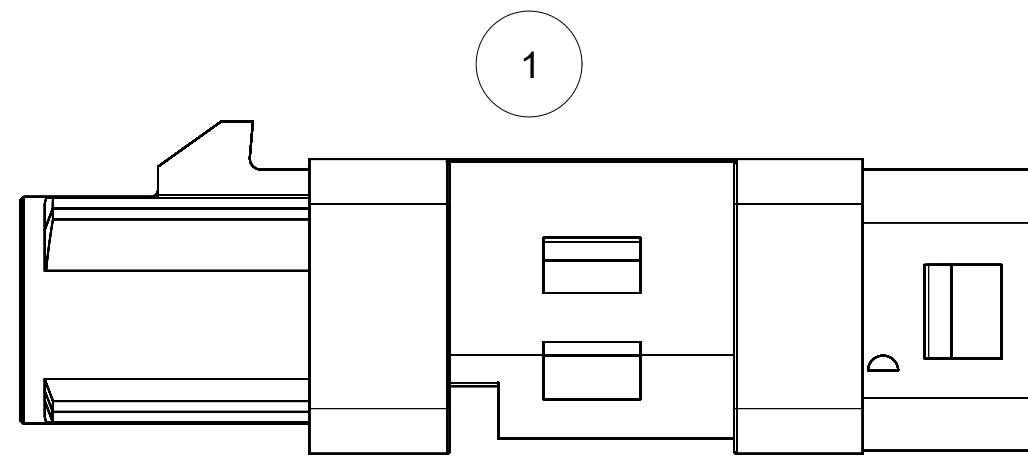

SHROUD

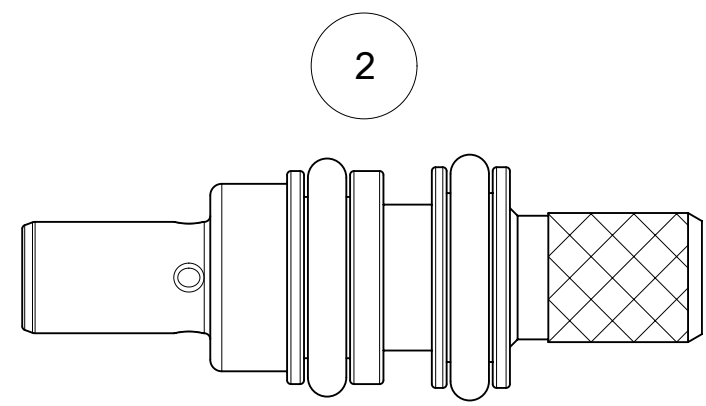

SMB SUB-ASSEMBLY

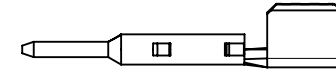

CONTACT  
(SHOWN LOOSE  
COMES ON T&R)

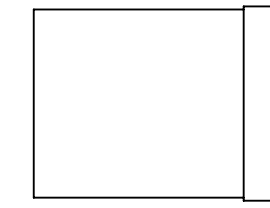

CRIMP TUBE

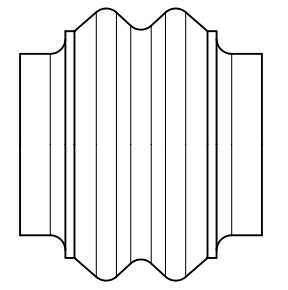

CABLE SEAL

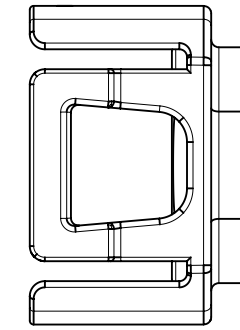

END CAP

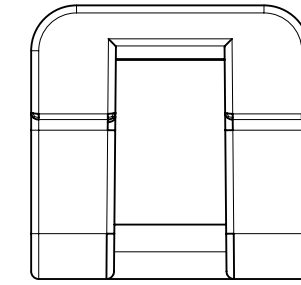

ISL NO CLIP SLOT

NOTES:

- 1. ITEM 2 TO BE TRAY PACKED.
- 2. ALL ITEMS MAY BE BAGGED INDIVIDUALLY TOGETHER WHEN SOLD AS 73403-1XXX ASSEMBLY NUMBER.
- 3. ITEMS 1/3/4/5/6/7 MAY BE INDIVIDUALLY BULK PACKED. BULK PACKAGE QUANTITIES MUST NOT INDUCE ANY DAMAGE TO PARTS.

|            |          |                 |            |              |               |            |            |            |            |
|------------|----------|-----------------|------------|--------------|---------------|------------|------------|------------|------------|
| 73403-1123 | N        | PASTEL GREEN    | 89558-9203 | 73404-3290   | 89556-2511    | 89558-7992 | 89558-9230 | 89558-9210 | 89558-8150 |
| 73403-1122 | M        | PASTEL ORANGE   | 89558-9202 | 73404-3290   | 89556-2511    | 89558-7992 | 89558-9230 | 89558-9210 | 89558-8150 |
| 73403-1121 | L        | CARMINE RED     | 89558-9201 | 73404-3290   | 89556-2511    | 89558-7992 | 89558-9230 | 89558-9210 | 89558-8150 |
| 73403-1120 | Z        | WATER BLUE      | 89558-9200 | 73404-3290   | 89556-2511    | 89558-7992 | 89558-9230 | 89558-9210 | 89558-8150 |
| 73403-1119 | K        | CURRY YELLOW    | 89558-9199 | 73404-3290   | 89556-2511    | 89558-7992 | 89558-9230 | 89558-9210 | 89558-8150 |
| 73403-1118 | I        | BEIGE           | 89558-9198 | 73404-3290   | 89556-2511    | 89558-7992 | 89558-9230 | 89558-9210 | 89558-8150 |
| 73403-1117 | H        | VIOLET          | 89558-9197 | 73404-3290   | 89556-2511    | 89558-7992 | 89558-9230 | 89558-9210 | 89558-8150 |
| 73403-1116 | G        | GRAY            | 89558-9196 | 73404-3290   | 89556-2511    | 89558-7992 | 89558-9230 | 89558-9210 | 89558-8150 |
| 73403-1115 | F        | BROWN           | 89558-9195 | 73404-3290   | 89556-2511    | 89558-7992 | 89558-9230 | 89558-9210 | 89558-8150 |
| 73403-1114 | E        | GREEN           | 89558-9194 | 73404-3290   | 89556-2511    | 89558-7992 | 89558-9230 | 89558-9210 | 89558-8150 |
| 73403-1113 | D        | BORDEAUX VIOLET | 89558-9193 | 73404-3290   | 89556-2511    | 89558-7992 | 89558-9230 | 89558-9210 | 89558-8150 |
| 73403-1112 | C        | BLUE            | 89558-9192 | 73404-3290   | 89556-2511    | 89558-7992 | 89558-9230 | 89558-9210 | 89558-8150 |
| 73403-1111 | B        | CREAM WHITE     | 89558-9191 | 73404-3290   | 89556-2511    | 89558-7992 | 89558-9230 | 89558-9210 | 89558-8150 |
| 73403-1110 | A        | BLACK           | 89558-9190 | 73404-3290   | 89556-2511    | 89558-7992 | 89558-9230 | 89558-9210 | 89558-8150 |
| PART NO.   | KEY CODE | COLOR           | ITEM NO. 1 | ITEM NO. 2   | ITEM NO. 3    | ITEM NO. 4 | ITEM NO. 5 | ITEM NO. 6 | ITEM NO. 7 |
|            |          |                 | SHROUD     | SMB SUB-ASSY | CONTACT (T&R) | CRIMP TUBE | CABLE SEAL | END CAP    | ISL NO CS  |

|   |  |  |  |  |
|---|--|--|--|--|
| QUALITY SYMBOLS<br>▽ = 0<br>▽ = 0<br>▽ = 0<br>▽ = 0<br>▽ = 0<br>▽ = 0<br>▽ = 0<br>▽ = 0<br>▽ = 0<br>▽ = 0 | THIS DRAWING CONTAINS INFORMATION THAT IS PROPRIETARY TO MOLEX ELECTRONIC TECHNOLOGIES, LLC AND SHOULD NOT BE USED WITHOUT WRITTEN PERMISSION<br>2017/09/07<br>2017/09/21<br>MIGRATED<br>EC NO: 122054<br>DRWN: BSHAH<br>CHKD:<br>REV / APPR: AROBERTSON | GENERAL TOLERANCES (UNLESS SPECIFIED)<br>METRIC      NTS<br>DRWN BY      DATE<br>LMEIER      2016/05/16  |  |  |
|   |  | 4 PLACES ±      ±<br>3 PLACES ±      ± 0.005<br>2 PLACES ± 0.13      ± 0.01<br>1 PLACES ± 0.25      ±<br>0 PLACES ±      ±<br>ANGULAR TOL = 2.0<br>DRAFT WHERE APPLICABLE<br>MUST REMAIN WITHIN DIMENSIONS |  |  |
| DRAWING SIZE      THIRD ANGLE PROJECTION<br>C   |  | DOCUMENT NUMBER      DOC TYPE      DOC PART      SHEET NUMBER<br>SD-73403-105      PSD      001      4 OF 4  |  |  |