

THESE DRAWINGS ARE THE PROPERTY OF QUALTEK ELECTRONICS AND NOT TO BE REPRODUCED FOR OR COMMUNICATED TO A THIRD PARTY WITHOUT THE EXPRESS WRITTEN PERMISSION OF AN OFFICER OF QUALTEK ELECTRONICS.

| REVISION | | | |
|----------|-------------------|----------|----------|
| REV. | DESCRIPTION | DATE | APPROVED |
| B | RoHS Compliancy | 06-01-06 | DP |
| C | Updated Approvals | 03-16-15 | LY |

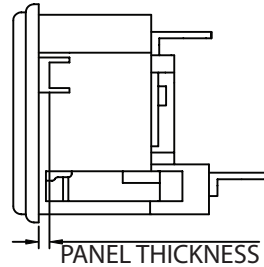
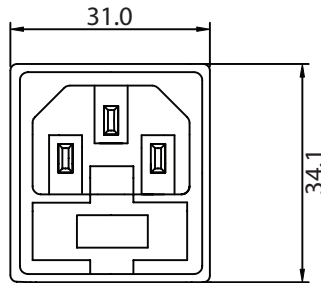

- 1.0
- 1.5
- 2.0
- 3.0

| PART NO. | DIM A | TERMINAL |
|-----------|-------|----------|
| 723A-*/28 | 38.0 | 2 |
| 723A-*/48 | 39.0 | 4 |
| 723A-*/63 | 39.0 | 5 |

** DENOTES PANEL THICKNESS

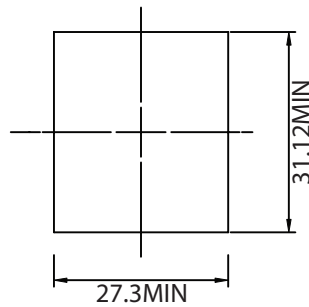
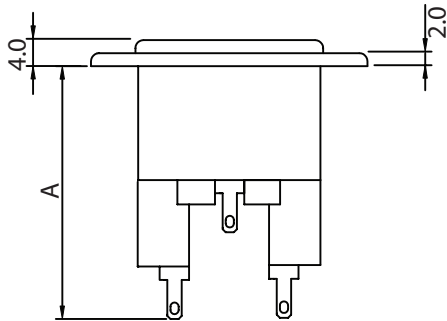

PANEL CUTOUT

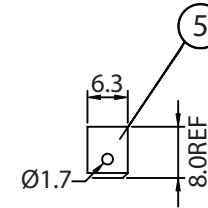
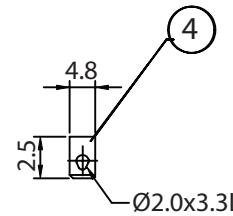
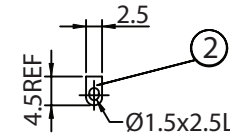

NOTES:

MATERIAL:

MOULDING: NYLON, FLAMMABILITY RATING UL 94V-0
 CONTACTS: BRASS, PINS NICKEL PLATED, TAGS TIN PLATED
 RATING: 10A 250V AC
 CONTACT RESISTANCE: <15m OHM(POLE)
 INSULATION RESISTANCE: >10³ OHM AT 500V DC
 AC BREAKDOWN:
 POLE-POLE: 6kV
 POLES-PANEL: 5.0kV
 OPERATING TEMPERATURE: -20° C TO +70° C
 MAX. PIN TEMPERATURE: +65° C
 DOUBLE FUSED 5x20mm
 APPROVALS: UL,CSA
 RoHS COMPLIANT

CONTROLLED

| Dim range (mm) | Tolerance +/- (mm) | Qualtek Electronics Corp. PPC DIVISION | | |
|----------------|--------------------|---|----------------|-----------------|
| | | Part Number: | 723A SERIES | RoHS Compliant |
| 0-1 | 0.15 | Description: AC RECEPTACLE | | |
| 1-6 | 0.20 | | UNIT: mm | REV. C |
| 6-18 | 0.30 | | | |
| 18-50 | 0.50 | Drawn / Date | Checked / Date | Approved / Date |
| 50-120 | 0.70 | B.Zhang 12-30-02 | 12-30-02 | JJH / 12-30-02 |
| 120-250 | 0.90 | | | |
| 250-500 | 1.20 | | | |