

THIS DRAWING IS UNPUBLISHED. RELEASED FOR PUBLICATION  
 © COPYRIGHT BY TYCO ELECTRONICS CORPORATION. ALL RIGHTS RESERVED.

LOC		DIST		REVISIONS			
P	LTR	DESCRIPTION	DATE	DWN	APVD		
D		REVISED	18JUN'10	T.T	T.N		

D

C

B

A

VACCU PICK UP AREA

∅20

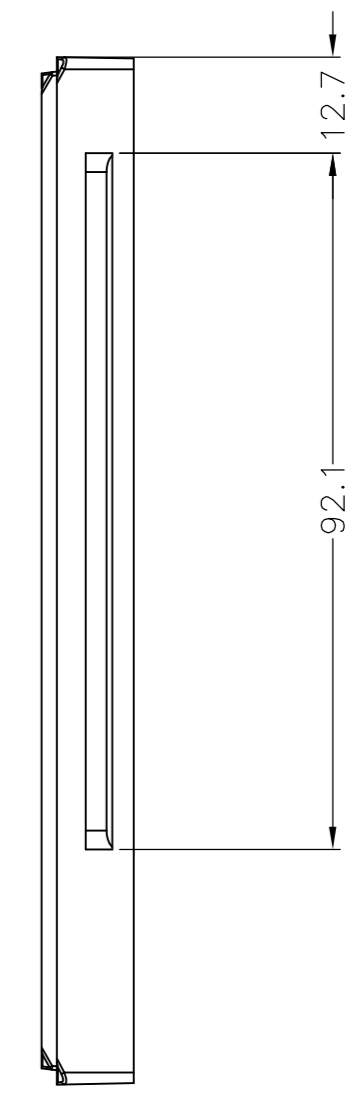
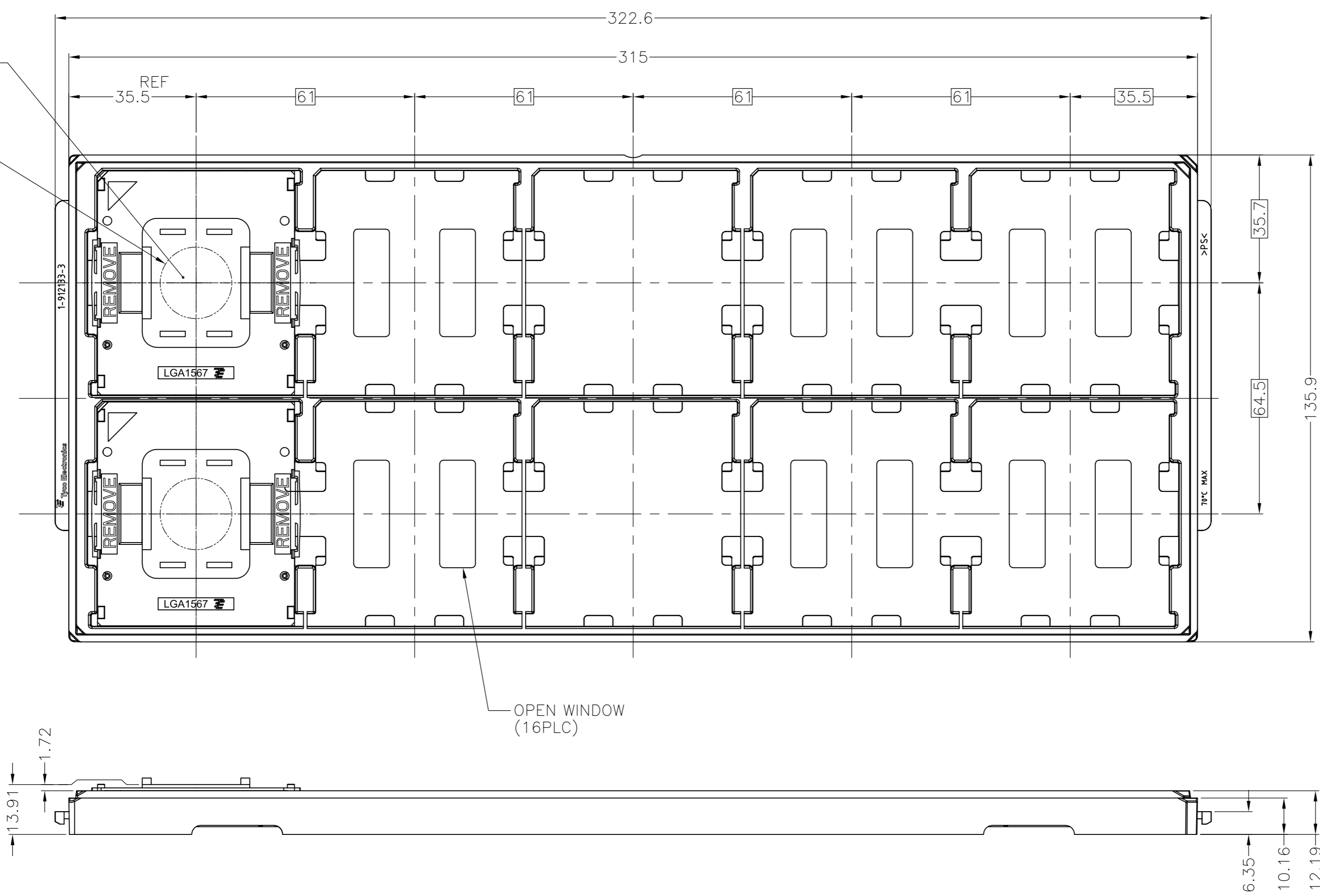

D

C

B

A

2040636

1. MATERIAL
- ① HOUSING : HIGH TEMP, THERMO-PLASTIC, UL94V-0, BLACK
  - ② CONTACT : COPPER ALLOY  
FINISH : Au PL. AT CONTACT AREA ON OVERALL OVER Ni UNDER PL. 0.00127 MIN.
  - ③ SOLDER BALL : Sn/Ag/Cu FOR LEAD FREE PRODUCT.
  - ④ CAP : HIGH TEMP. THERMO-PLASTIC, UL94V-0, BLACK
- △ INDICATED DATE CODE ON THE HSG

SUPERSEDED BY -5

2040636-5	0.76um MIN.	RECOMMENDED FOR N2 REFLOW PROCESS
2040636-4	0.76um MIN.	RECOMMENDED FOR AIR REFLOW PROCESS
2040636-3	0.38um MIN.	RECOMMENDED FOR AIR REFLOW PROCESS
<del>2040636-2</del>	<del>0.76um MIN.</del>	<del>RECOMMENDED FOR N2 REFLOW PROCESS</del>
2040636-1	0.38um MIN.	RECOMMENDED FOR N2 REFLOW PROCESS
PART NUMBER	Au THICKNESS AT CONTACT AREA	DESCRIPTION

THIS DRAWING IS A CONTROLLED DOCUMENT.		DWN T.TOKUNAGA 12AUG2009	Tyco Electronics Corporation Kawasaki, Japan	
		CHK H.TAGUCHI 12AUG2009		
		APVD S.HASHIMOTO 12AUG2009	NAME	
		PRODUCT SPEC	SOCKET ASSY LGA1567	
		APPLICATION SPEC	108-78666	
		114-5463	SIZE	
		WEIGHT 19.5g	CAGE CODE 00779	
		CUSTOMER DRAWING	DRAWING NO C=2040636	
			RESTRICTED TO	
			SCALE NTS SHEET 1 OF 4 REV D	

THIS DRAWING IS UNPUBLISHED. RELEASED FOR PUBLICATION  
 © COPYRIGHT BY TYCO ELECTRONICS CORPORATION. ALL RIGHTS RESERVED.

LOC		DIST		REVISIONS			
P	LTR	DESCRIPTION	DATE	DWN	APVD		
-	-	SEE SHEET 1	-	-	-		

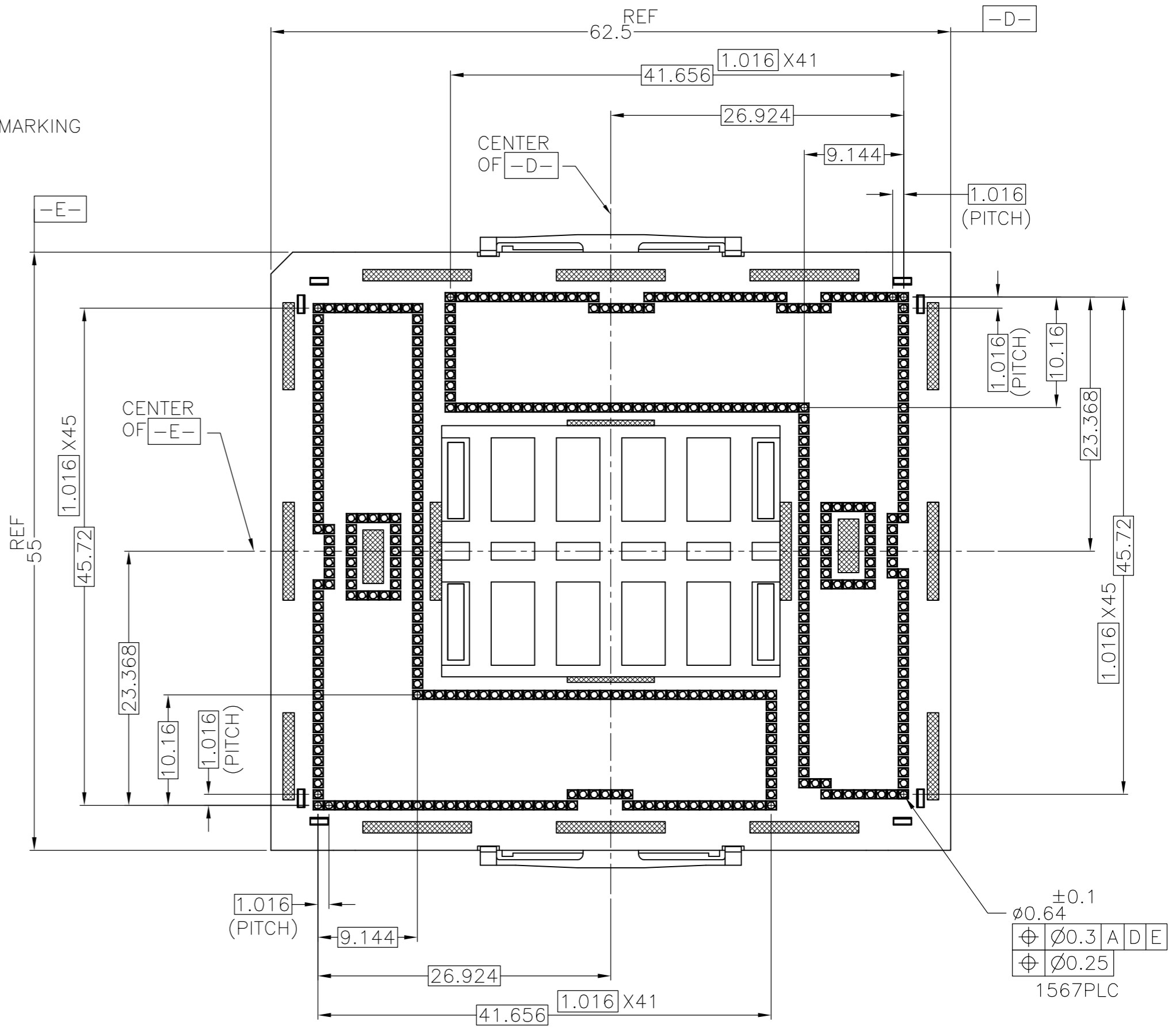
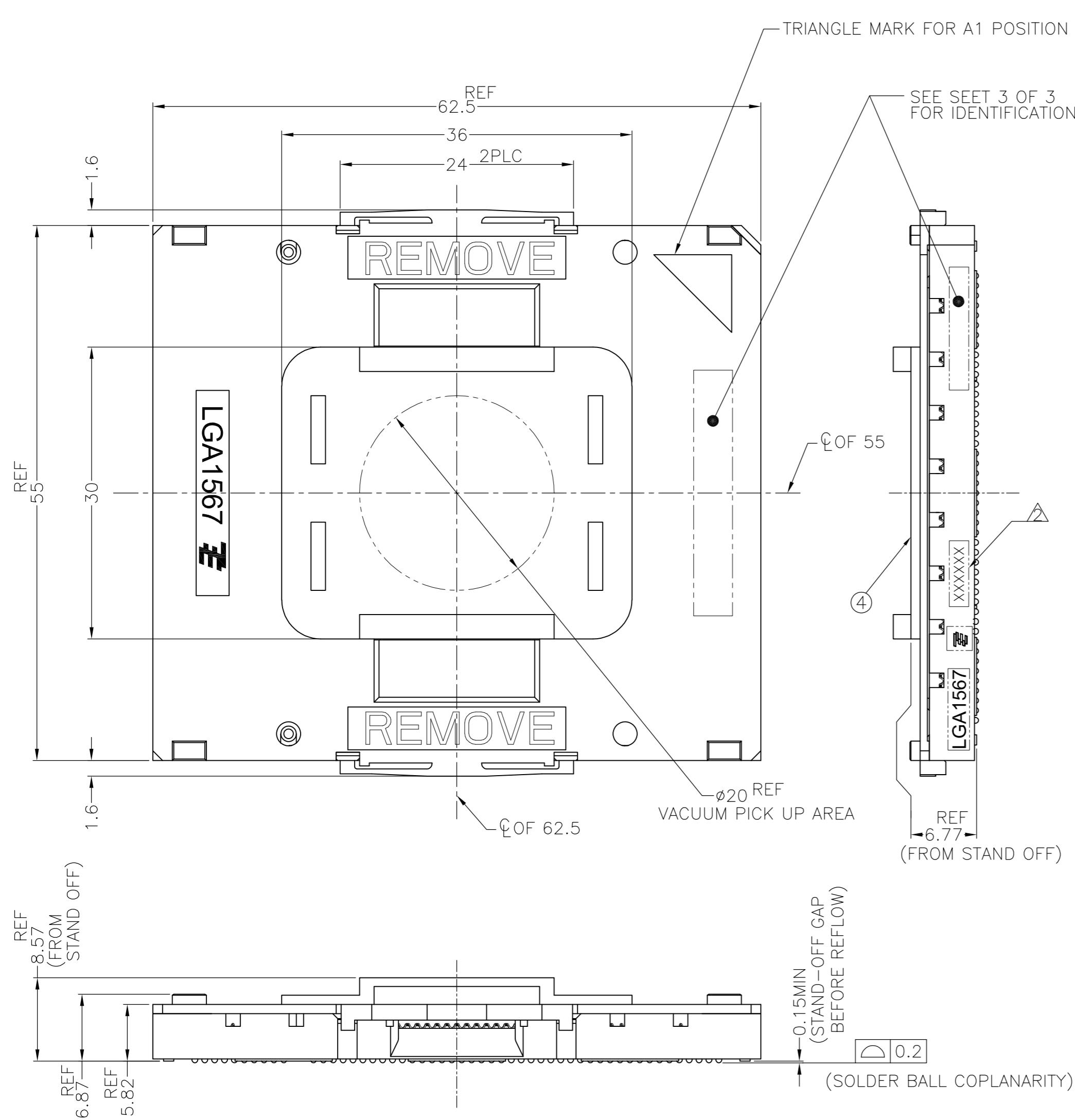

THIS DRAWING IS A CONTROLLED DOCUMENT.		DWN	Tyco Electronics Corporation Kawasaki, Japan	
DIMENSIONS: mm		CHK	NAME	
TOLERANCES UNLESS OTHERWISE SPECIFIED:		APVD	SOCKET ASSY LGA1567	
0 PLC ±	±0.3	PRODUCT SPEC	SIZE	CAGE CODE
1 PLC ±	±3	APPLICATION SPEC	A2	00779
2 PLC ±		WEIGHT	DRAWING NO	C=2040636
3 PLC ±		CUSTOMER DRAWING	RESTRICTED TO	-
4 PLC ±		SCALE	SHEET	REV
ANGLES ±		NTS	2 OF 4	D
FINISH				



THIS DRAWING IS UNPUBLISHED. RELEASED FOR PUBLICATION  
 © COPYRIGHT BY TYCO ELECTRONICS CORPORATION. ALL RIGHTS RESERVED.

LOC		DIST		REVISIONS			
P	LTR	DESCRIPTION	DATE	DWN	APVD		
-	-	SEE SHEET 1	-	-	-		

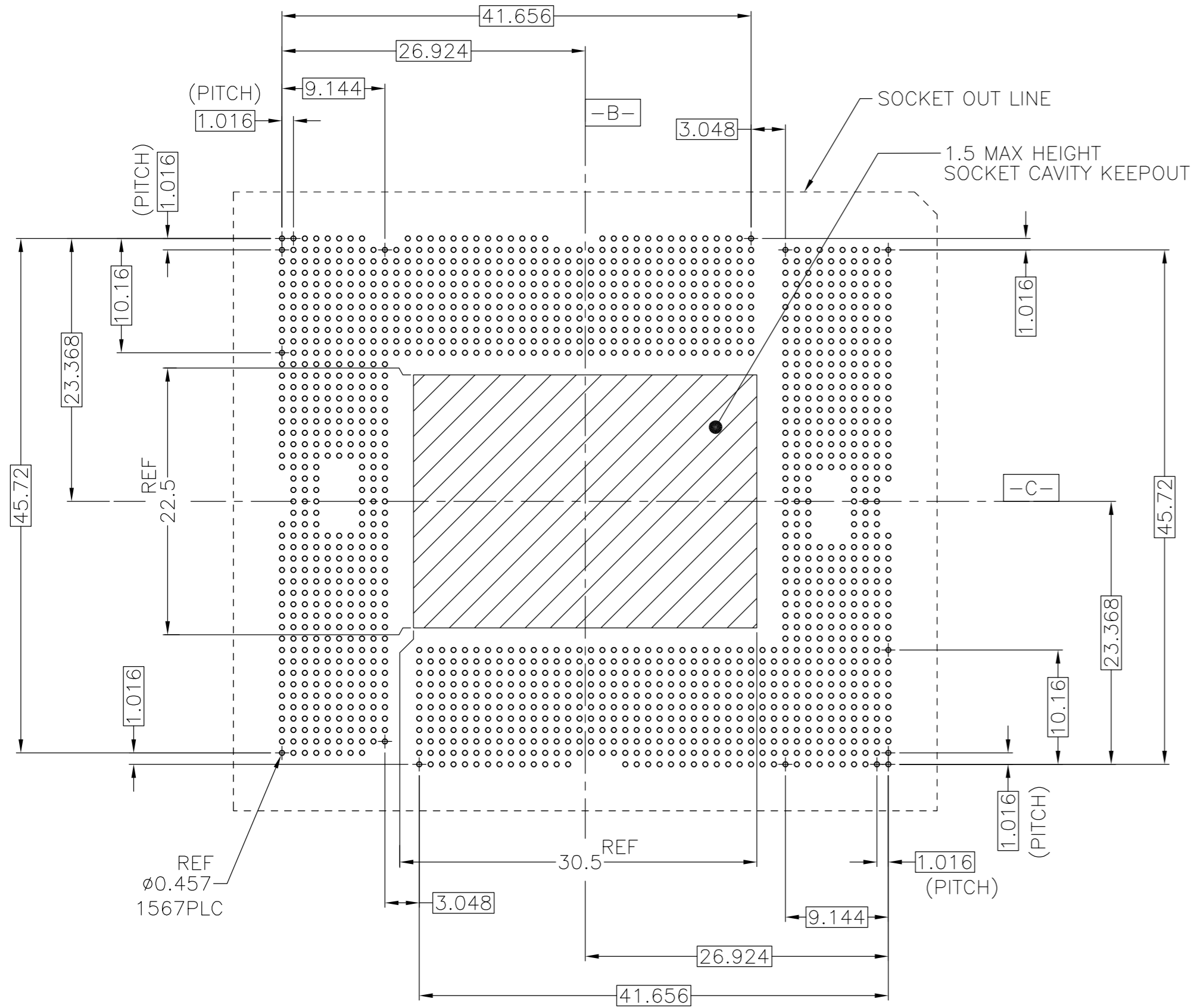

REFERENCE PATTERN LAYOUT

FOR GENERAL BOARD DESIGN, PLEASE REFER TO THE THERMAL AND MECHANICAL DESIGN GUIDELINES(TMDG) PROVIDED BY INTEL CORPORATION

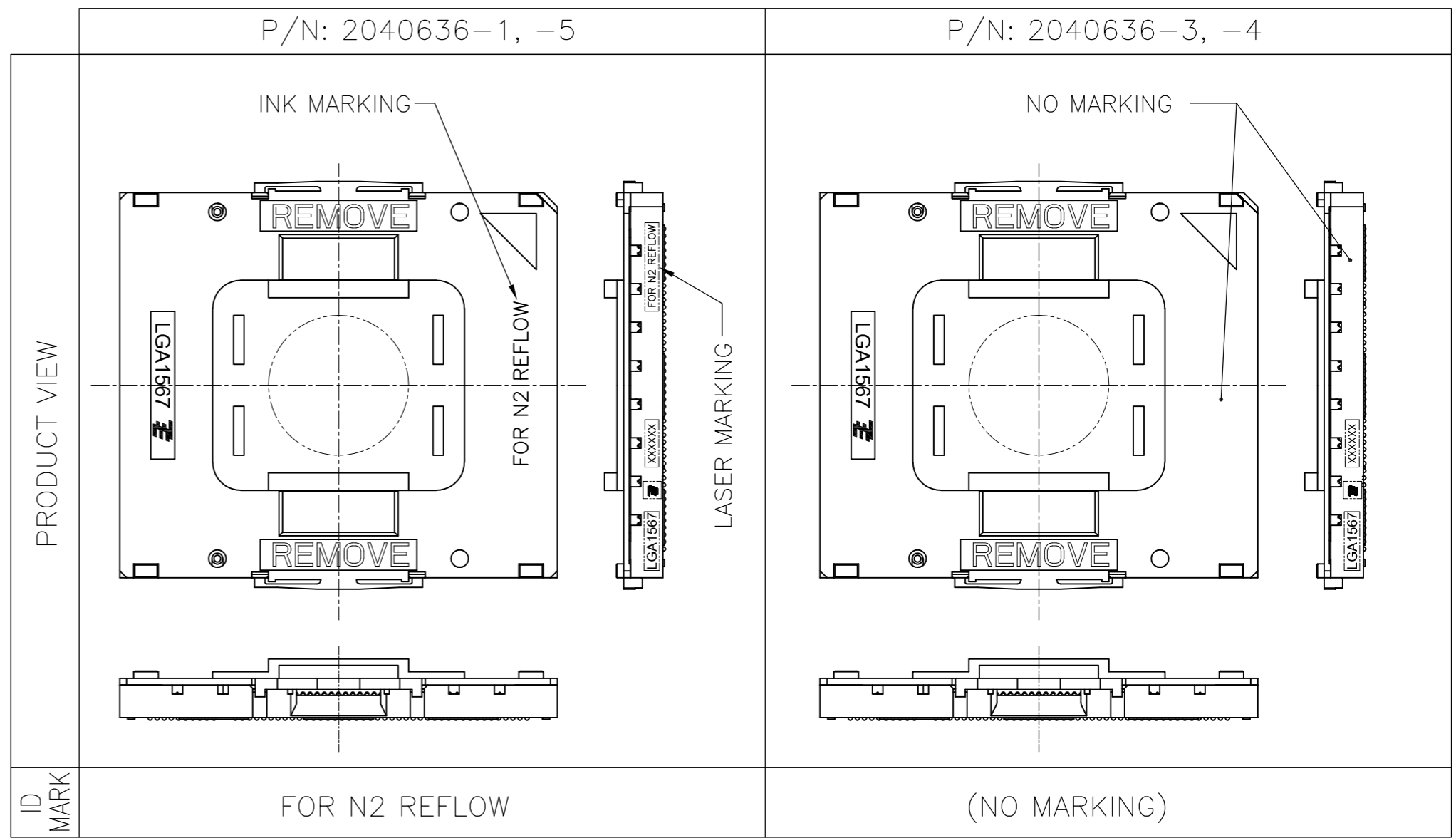

THIS DRAWING IS A CONTROLLED DOCUMENT.		DWN	Tyco Electronics Corporation Kawasaki, Japan	
DIMENSIONS:	TOLERANCES UNLESS OTHERWISE SPECIFIED:	CHK	NAME	
mm	0 PLC ± 0.3 1 PLC ± 0.3 2 PLC ± 0.3 3 PLC ± 0.3 4 PLC ± 0.3 ANGLES ± 3°	APVD	SOCKET ASSY LGA1567	
MATERIAL	FINISH	PRODUCT SPEC	SIZE	RESTRICTED TO
		APPLICATION SPEC	A2	-
		WEIGHT	CAGE CODE	DRAWING NO
		CUSTOMER DRAWING	00779	C=2040636
		SCALE	NTS	SHEET 4 OF 4
				REV D