

DATE CODE LOCATION
SEE NOTE 6

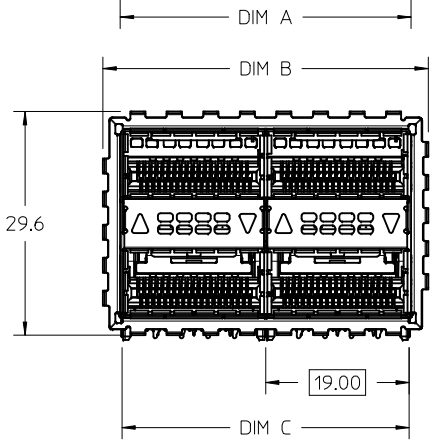

FRONT PLATE OPTIONS

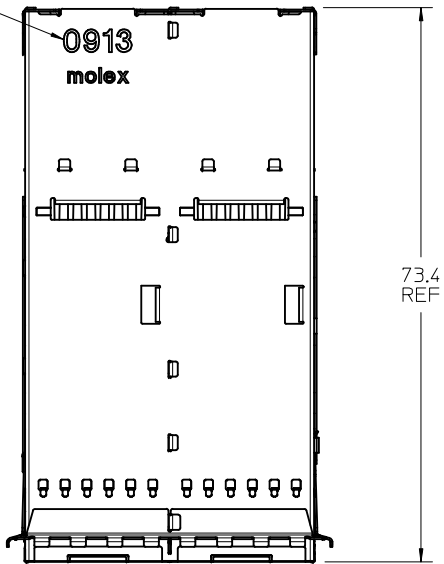
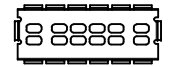

P/N 171565-*001
AIRFLOW ONLY
NO LIGHTPIPE

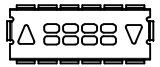

P/N 171565-*002
UP / DOWN LIGHTPIPE
INDICATOR

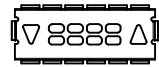

P/N 171565-*003
DOWN / UP LIGHTPIPE
INDICATOR

PORT SIZE	PART NUMBER	DIM 'A'	DIM 'B'	DIM 'C'
2X1	171565-100*	19.5	24.1	19.00
2X2	171565-000*	38.5	43.1	38.00
2X3	171565-300*	57.5	62.1	57.00

* - DESIGNATES FRONT PLATE OPTIONS

NOTES:

- MATERIAL:
 - CAGE: NICKEL SILVER, 0.25 THICK
 - EMI STRAPS: PHOS-BRONZE, 0.10 THICK
 - GASKET: SILICONE
 - LIGHT PIPES (OPTIONAL): POLYCARBONATE, 94V-0
 - CONNECTOR HOUSING: HIGH PERFORMANCE THERMOPLASTIC, 94V-0
 - TERMINALS: HIGH PERFORMANCE COPPER ALLOY, 0.18 THICK
- FINISH:
 - SPRING FINGERS: 100µm NICKEL OVERALL
 - GASKET: SILVER
 - TERMINALS: CONTACT AREA: 0.76µm MIN GOLD OVER 2.5µm MIN NICKEL. COMPLIANT AREA: 0.76-1.52µm MATTE TIN OVER 1.27µm MIN NICKEL.
- ALL SURFACES TO BE CLASS 'C' OR BETTER PER MOLEX COSMETIC SPECIFICATION PS-45499-002.
- REFER TO PK-76871-9001 FOR ALL PACKAGING SPECIFICATIONS.
- CONNECTOR INTENDED TO MATE WITH PLUG CABLE SERIES 74757 AND 74758.
- DATE CODE LOCATION SHOWN, DATE CODE FORMAT: DDDY
DDD = DAY OF THE YEAR, Y = YEAR.

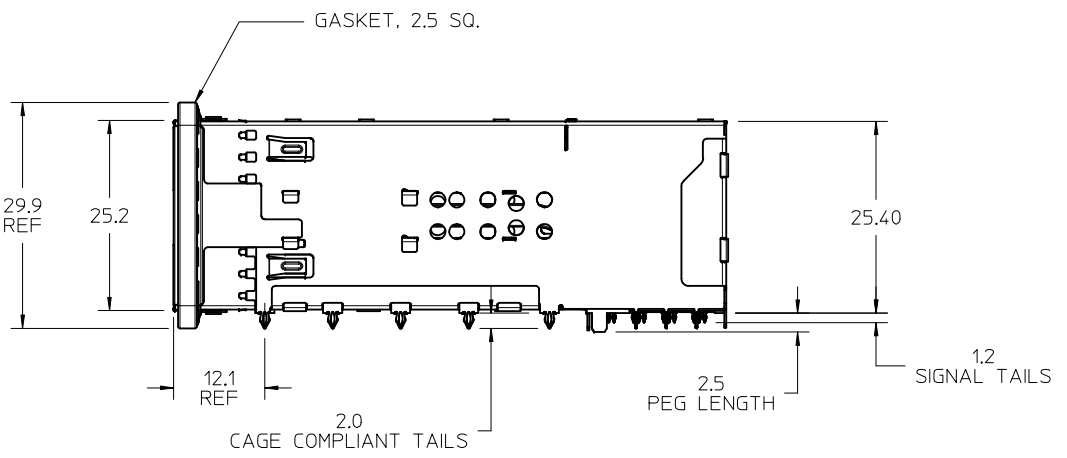

171565-000* SHOWN FOR REFERENCE
APPEARANCE MAY VARY BY SIZE

ADD NOTE SIDE VIEW EC NO: UCP2015-4862 DRWN: JKACHLIC 2015/05/19 CHKD: APPR: MBANAKIS 2015/05/20	QUALITY SYMBOLS	GENERAL TOLERANCES (UNLESS SPECIFIED)	DIMENSION STYLE MM ONLY	SCALE	DESIGN UNITS METRIC	THIRD ANGLE PROJECTION
	▽=0	mm INCH	DRAWN BY DATE JKACHLIC 2012/08/23	TITLE	ZQSFP+ STACKED ASSY W/ELASTOMERIC GASKET	
	▽=0	4 PLACES ± --- ± ---	CHECKED BY DATE	APPROVED BY DATE MBANAKIS 2012/08/30		
	▽=0	3 PLACES ± --- ± ---	MATERIAL NO.	DOCUMENT NO.	SHEET NO.	
		ANGULAR ±1/2°	SEE CHART	SD-171565-2000		1 OF 3
		DRAFT WHERE APPLICABLE MUST REMAIN WITHIN DIMENSIONS	THIS DRAWING CONTAINS INFORMATION THAT IS PROPRIETARY TO MOLEX INCORPORATED AND SHOULD NOT BE USED WITHOUT WRITTEN PERMISSION			

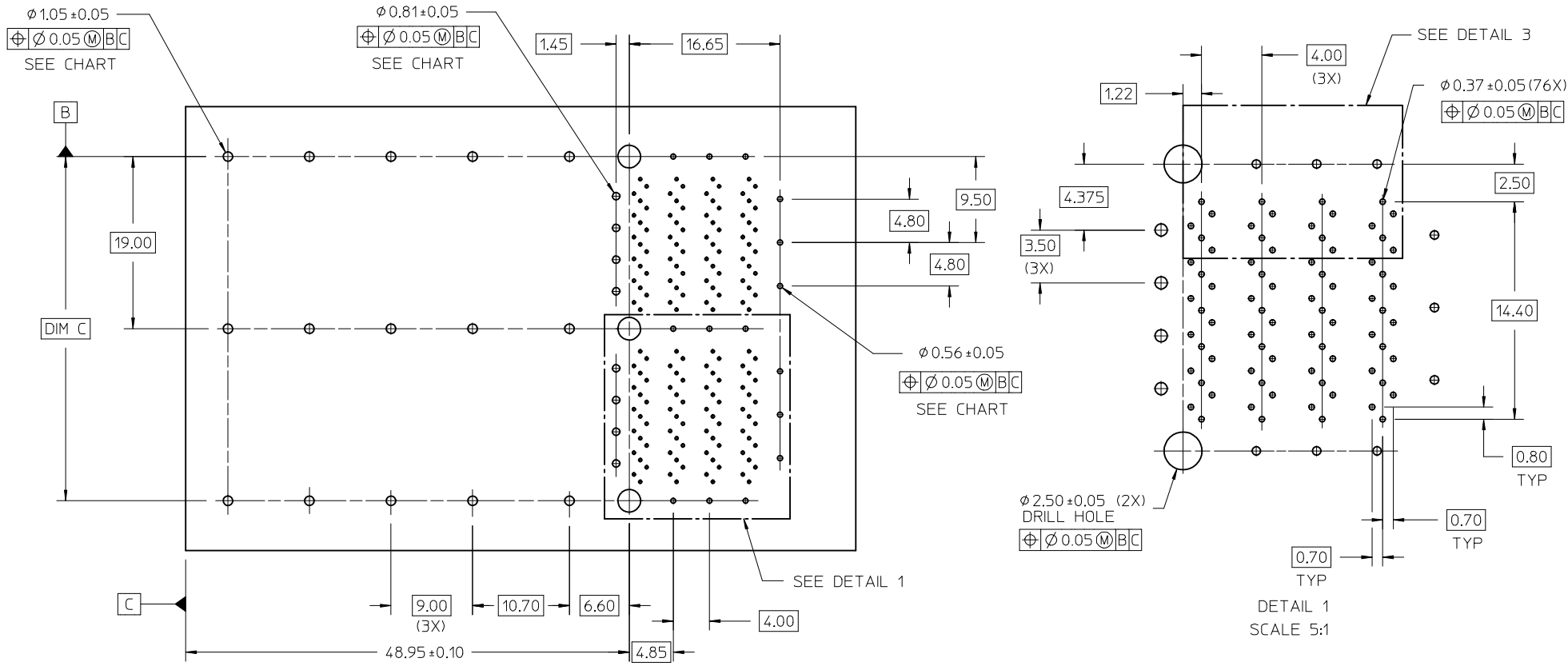

$\phi 2.50 \pm 0.05$ (2X)
 DRILL HOLE
 $\oplus \phi 0.05 \text{ (M) B/C}$

DETAIL 1
 SCALE 5:1

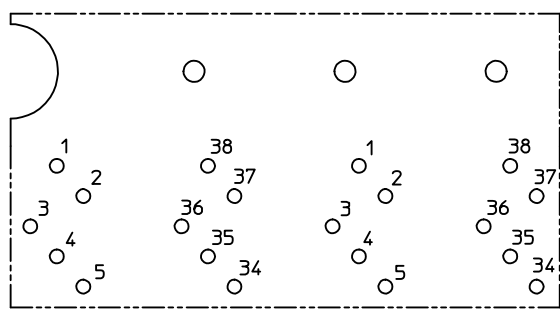

LOWER PORT UPPER PORT

DETAIL 3
 PIN ASSIGNMENTS

PORT SIZE	DIM C	1.05 ϕ PTH QUANTITY	0.56 ϕ PTH QUANTITY	0.81 ϕ PTH QUANTITY
2X1	19.00	10	9	4
2X2	38.00	15	15	8
2X3	57.00	20	21	12

SEE SHEET 1 EC NO: UCP2015-4862 DRWN: JKACHLIC 2015/05/19 CHKD: APPR: MBANAKIS 2015/05/20	QUALITY SYMBOLS $\nabla = 0$ $\nabla = 0$ $\nabla = 0$	GENERAL TOLERANCES (UNLESS SPECIFIED) <table border="1"> <tr> <th></th> <th>mm</th> <th>INCH</th> </tr> <tr> <td>4 PLACES</td> <td>\pm ---</td> <td>\pm ---</td> </tr> <tr> <td>3 PLACES</td> <td>\pm ---</td> <td>\pm ---</td> </tr> <tr> <td>2 PLACES</td> <td>± 0.13</td> <td>\pm ---</td> </tr> <tr> <td>1 PLACE</td> <td>± 0.25</td> <td>\pm ---</td> </tr> <tr> <td>0 PLACE</td> <td>\pm ---</td> <td>\pm ---</td> </tr> </table>		mm	INCH	4 PLACES	\pm ---	\pm ---	3 PLACES	\pm ---	\pm ---	2 PLACES	± 0.13	\pm ---	1 PLACE	± 0.25	\pm ---	0 PLACE	\pm ---	\pm ---	DIMENSION STYLE MM ONLY DRAWN BY: JKACHLIC DATE: 2012/08/23 CHECKED BY: DATE:	SCALE: 3:1 DESIGN UNITS: METRIC THIRD ANGLE PROJECTION
		mm	INCH																			
	4 PLACES	\pm ---	\pm ---																			
	3 PLACES	\pm ---	\pm ---																			
2 PLACES	± 0.13	\pm ---																				
1 PLACE	± 0.25	\pm ---																				
0 PLACE	\pm ---	\pm ---																				
DRAFT WHERE APPLICABLE MUST REMAIN WITHIN DIMENSIONS		APPROVED BY: MBANAKIS DATE: 2012/08/30 MATERIAL NO.:	TITLE: ZQSFP+ STACKED ASSY W/ELASTOMERIC GASKET																			
		SEE CHART	DOCUMENT NO.: SD-171565-2000																			
		SIZE: C	THIS DRAWING CONTAINS INFORMATION THAT IS PROPRIETARY TO MOLEX INCORPORATED AND SHOULD NOT BE USED WITHOUT WRITTEN PERMISSION																			

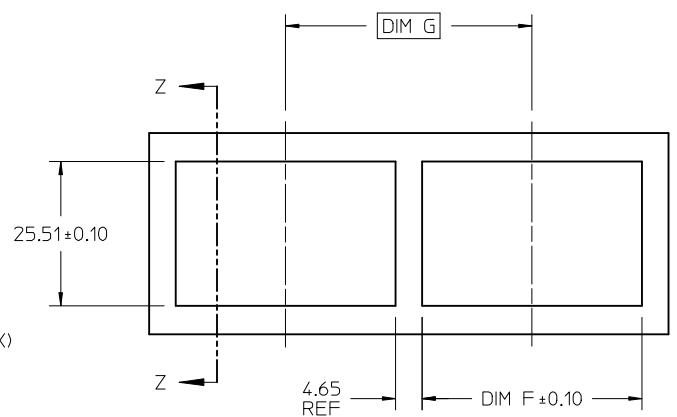
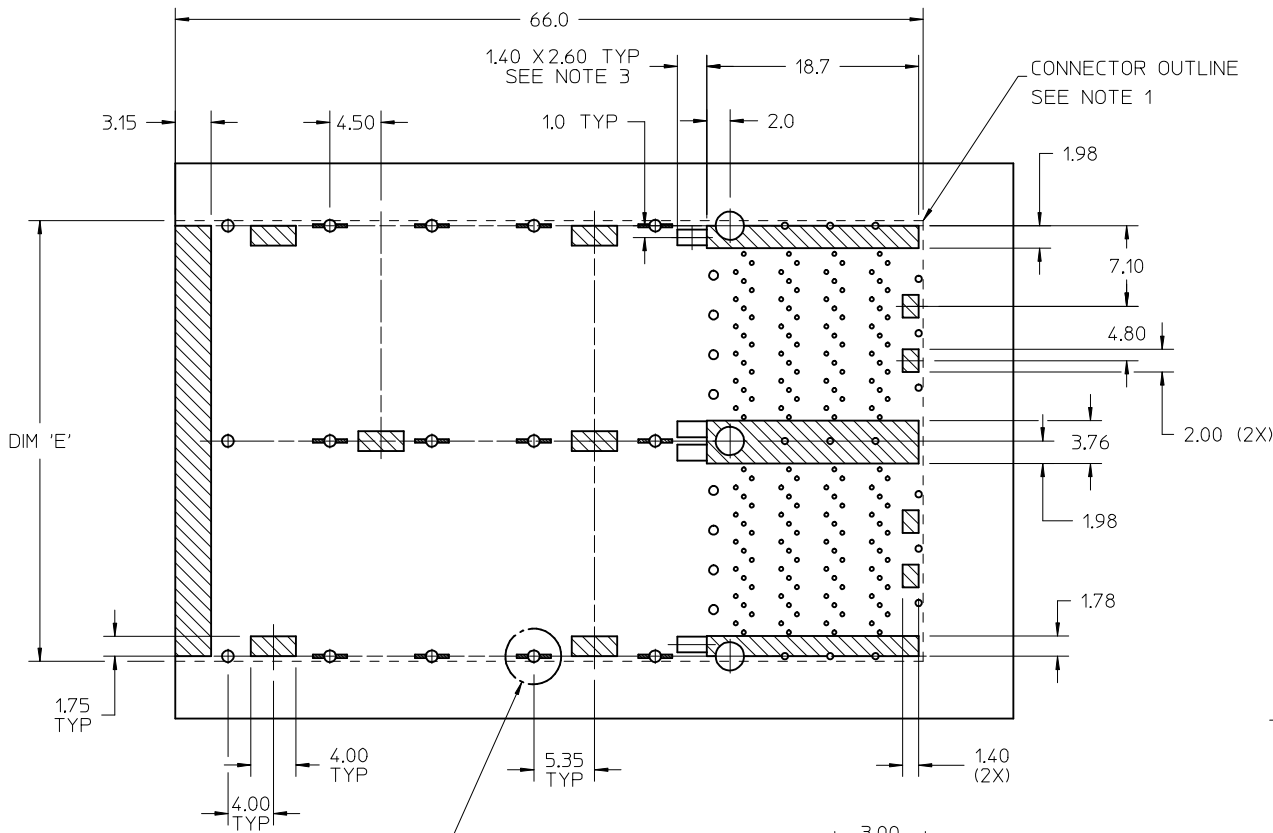

PANEL OPENING REQUIREMENTS

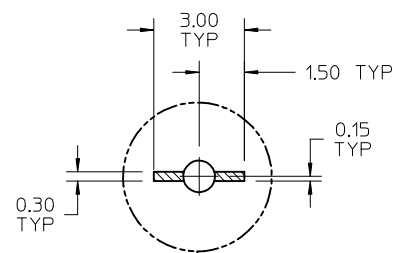

DETAIL 2
SCALE 8:1

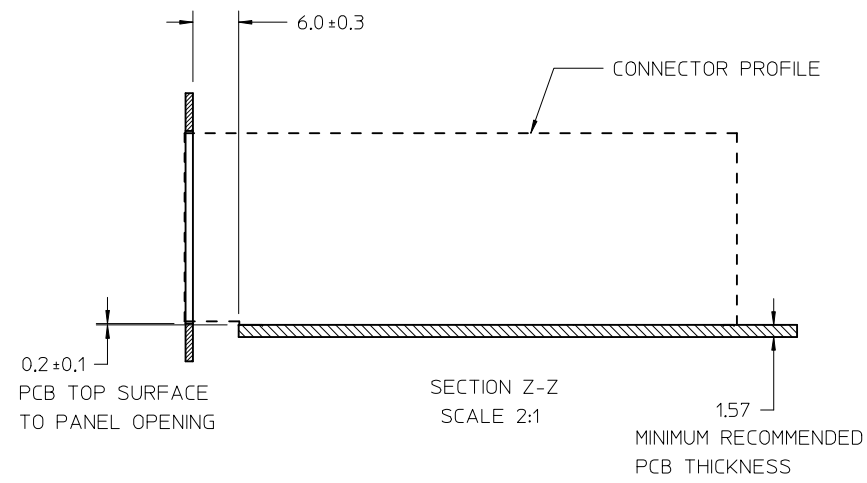

SECTION Z-Z
SCALE 2:1

PORT SIZE	DIM 'E'	DIM 'F'	DIM 'G'
2X1	19.5	19.85	24.50
2X2	38.5	38.85	43.50
2X3	57.5	57.85	62.50

NOTES:

1. THE ENTIRE AREA UNDER THE CONNECTOR IS A COMPONENT KEEP-OUT ZONE.
2. CROSS HATCHED AREAS INDICATE PLACES WHERE THE PLASTIC HOUSING AND METAL CAGE MAY BE IN CONTACT WITH THE PCB SURFACE. THESE AREAS ARE THE TRACE KEEP-OUT ZONES.
3. THESE RECTANGULAR ZONES ARE FOR LED PLACEMENT. LED HEIGHT SHOULD NOT EXCEED 0.8 AND PLACEMENT SHOULD BE CENTERED WITHIN THIS LED KEEP-IN ZONE.
4. RECOMMENDED LED CHIP PACKAGE SIZE IS 0805.

SEE SHEET 1 EC NO: UCP2015-4862 DRAWN: JKACHLIC 2015/05/19 CHKD: MBANAKIS 2015/05/20 APPR: MBANAKIS 2015/05/20	QUALITY SYMBOLS ∇=0 ∇=0 ∇=0	GENERAL TOLERANCES (UNLESS SPECIFIED) <table border="1"> <thead> <tr> <th></th> <th>mm</th> <th>INCH</th> </tr> </thead> <tbody> <tr> <td>4 PLACES</td> <td>± ---</td> <td>± ---</td> </tr> <tr> <td>3 PLACES</td> <td>± ---</td> <td>± ---</td> </tr> <tr> <td>2 PLACES</td> <td>± 0.13</td> <td>± ---</td> </tr> <tr> <td>1 PLACE</td> <td>± 0.25</td> <td>± ---</td> </tr> <tr> <td>0 PLACE</td> <td>± ---</td> <td>± ---</td> </tr> </tbody> </table>		mm	INCH	4 PLACES	± ---	± ---	3 PLACES	± ---	± ---	2 PLACES	± 0.13	± ---	1 PLACE	± 0.25	± ---	0 PLACE	± ---	± ---	DIMENSION STYLE MM ONLY DRAWN BY: JKACHLIC DATE: 2012/08/23 CHECKED BY: DATE:	SCALE: 1:1 DESIGN UNITS: METRIC THIRD ANGLE PROJECTION
		mm	INCH																			
	4 PLACES	± ---	± ---																			
	3 PLACES	± ---	± ---																			
2 PLACES	± 0.13	± ---																				
1 PLACE	± 0.25	± ---																				
0 PLACE	± ---	± ---																				
DRAFT WHERE APPLICABLE MUST REMAIN WITHIN DIMENSIONS		ANGULAR ±1/2° MATERIAL NO.	APPROVED BY: MBANAKIS DATE: 2012/08/30 SEE CHART	TITLE: ZQSFP+ STACKED ASSY W/ELASTOMERIC GASKET molex																		
		SIZE: C	DOCUMENT NO. SD-171565-2000	SHEET NO. 3 OF 3																		
THIS DRAWING CONTAINS INFORMATION THAT IS PROPRIETARY TO MOLEX INCORPORATED AND SHOULD NOT BE USED WITHOUT WRITTEN PERMISSION																						