

PART NUMBER 127-0000-901	MATERIAL STAINLESS STEEL PASSIVATED
-----------------------------	---

DRAWING NO. C - 127-0000-901					
0	REVISIONS				
ENGINEERING RELEASE					
1	3-15-07	P A T	J R K	M D J U	4-4-07 ECN 50967
VERSION UPDATE					
***** * REVISION NUMBER FOLLOWED BY AN ALPHA * * CHARACTER INDICATES DRAWING CLARIFI- * * CATION OR PART NUMBER ADDITION ONLY. * *****					
1a	6-24-08	P A T	J R K	M D J U	6-24-08 ECN 51555

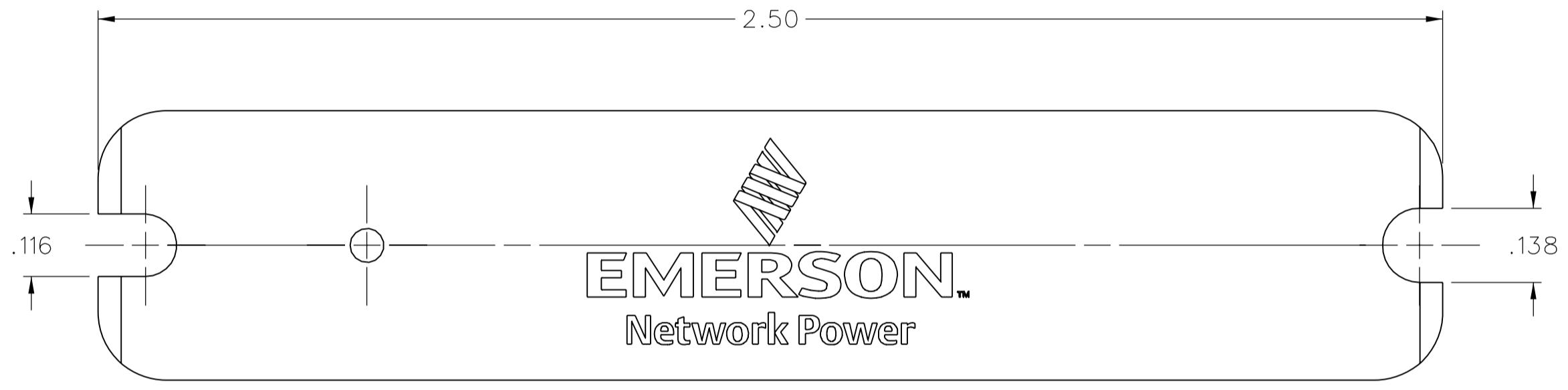
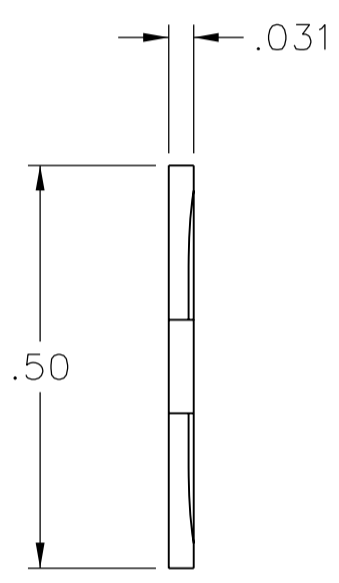
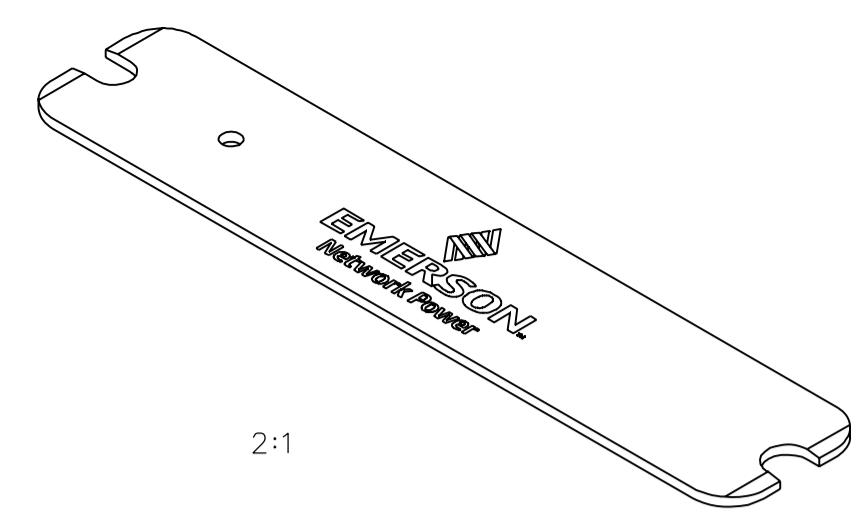

CUSTOMER DRAWING

THIS DRAWING TO BE INTERPRETED
PER ASME Y 14.5M - 1994

"μSTATION"

COMPANY CONFIDENTIAL

TOLERANCE UNLESS OTHERWISE SPECIFIED		DRAWN BY PAT	DATE 2-5-07
DECIMALS	mm	CHECKED BY JRK	DATE 4-2-07
.XX REF	_____	APPROVED BY PDW	DATE 4-2-07
.XXX REF	_____	RELEASE DATE	4-4-07
MATL	_____	U/M	INCH
FINISH	_____	SCALE	4:1

cinch Connectivity Solutions
P.O. Box 1732
Waseca, MN 56093
1-800-247-8256

TITLE
SMP CABLED CONNECTOR
REMOVAL TOOL

SHEET
2 OF 2

DRAWING NO.
C - 127-0000-901