

Figure 1

## 1. INTRODUCTION

Spool Kits 217435-2 and 1583089-1 consist of a spool return spring, two seals, a spool cap, and a retaining screw. These components are used to replace the worn components on 626 Pneumatic Tooling Assembly 189721-[ ] (hand-actuated system without logic). See Figure 1 for the repair kit to spool valve cross-reference. For detailed information concerning the pneumatic tooling assembly, refer to Customer Manual 409-5862.



**NOTE** Kit components are available separately. Figure 2 lists the individual part numbers.



**DANGER** When tool is connected to main air supply, the piston will retract; when tool is actuated, piston will extend. To avoid personal injury, keep hands and fingers away from the front of the tool.

## 2. ASSEMBLY PROCEDURE

1. DISCONNECT PNEUMATIC TOOL FROM MAIN AIR SUPPLY.

2. Remove the retaining screw on the end of the tool switch lever. Slide the pivot base until the end of the switch lever clears the hole in the top of the spool valve.

## 3. REVISION SUMMARY

Since the previous version of this document, the following changes were made:

- Updated document to corporate requirements.

† Product of Dow Corning Corporation, Midland, MI

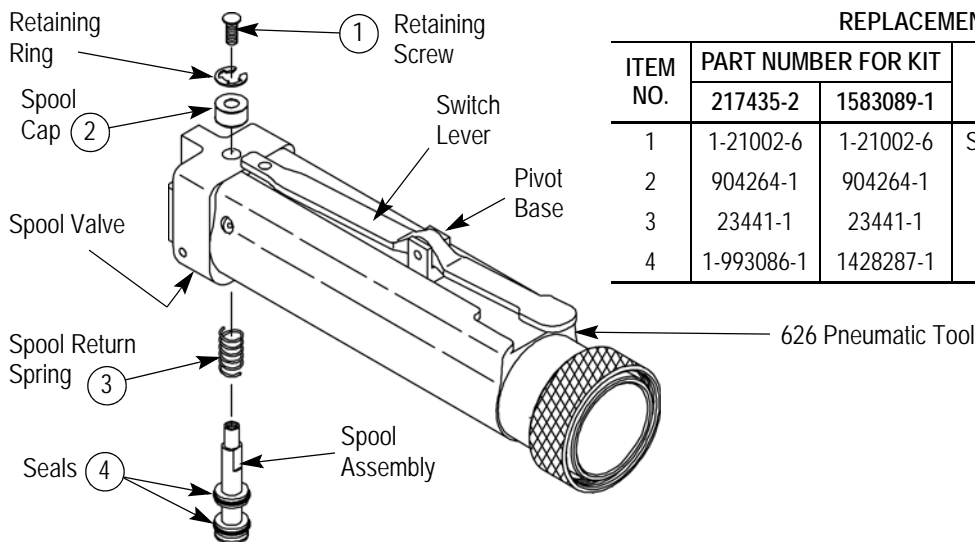

Figure 2

### REPLACEMENT PARTS

ITEM NO.	PART NUMBER FOR KIT		DESCRIPTION	QTY PER KIT
	217435-2	1583089-1		
1	1-21002-6	1-21002-6	Scr, Btn Hd, 6-32x.250"	1
2	904264-1	904264-1	Cap, Spool	1
3	23441-1	23441-1	Spring, Compression	1
4	1-993086-1	1428287-1	Seal, Spool	2