

DWG. NO. SD-51234-004

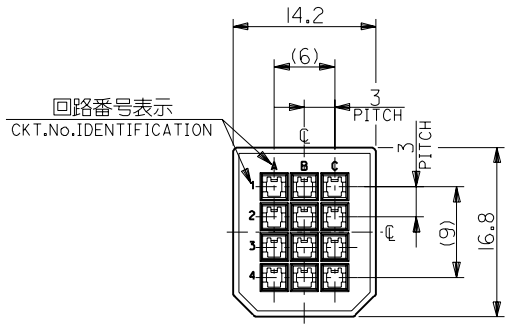

嵌合側  
MATING SIDE

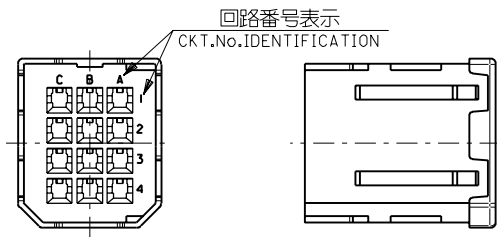
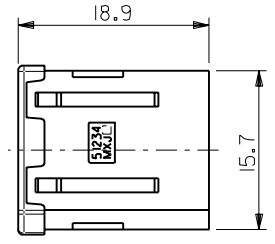

電線挿入側  
WIRE SIDE

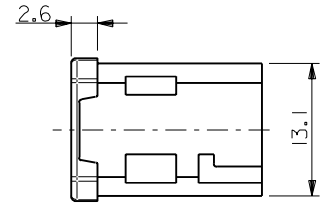

注記  
NOTES

1. 材質  
MATERIAL  
ガラス入りPBT樹脂 UL94V-0 色:黒  
HOUSING : PBT G.F. UL94V-0 COLOR : BLACK
2. 適用端子 : 56116-8\*90 , 56117-8\*90  
56118-8\*90 , 56119-8\*90  
APPLICABLE CRIMP PIN : 56116-8\*90 , 56117-8\*90  
56118-8\*90 , 56119-8\*90
3. 適用シエルボディ : 56380-1200  
APPLICABLE SHELL BODY : 56380-1200
4. 適用シエルカバー : 56381-1200  
APPLICABLE SHELL COVER : 56381-1200
5. 嵌合相手 : 51238-121\*  
MEET WITH : 51238-121\*

<誤嵌合防止キー (極性) タイプ> <POLARITY KEY TYPE>

51234-1201	51234-1202	51234-1203	51234-1204	51234-1205
STANDARD TYPE	A TYPE	B TYPE	C TYPE	D TYPE

A-2	D	51234-1205	51234-**0*	12
C-3	C	51234-1204		
B-3	B	51234-1203		
B-2	A	51234-1202		
—	STANDARD	51234-1201		
POLARITY POSITION (CIRCUIT No.)	POLARITY TYPE	MATERIAL No.	MODEL No.	CIRCUIT

DO NOT SCALE DRAWING

EC NO. DRWN: CHK: APPR:	EC NO. DRWN: CHK: APPR:	EC NO. DRWN: CHK: APPR:	REVISED 01/10/04 EC NO. J2002-0786 DRWN: S.AKIYAMA CHK: J.MIYAZAWA APPR: Y.O.ITO	RELEASED 01/02/09 EC NO. J2001-10440 DRWN: S.AKIYAMA CHK: J.MIYAZAWA APPR: H.IKESUGI	MATERIAL 材料 注記参照 SEE NOTES	GENERAL TOLERANCES: (UNLESS SPECIFIED) 一般公差	SCALE 2-1	DESIGN UNITS <input checked="" type="checkbox"/> mm <input type="checkbox"/> INCH	THIRD ANGLE PROJECTION	DIMENSIONS: <input type="checkbox"/> mm <input type="checkbox"/> INCH <input checked="" type="checkbox"/> mm ONLY	SHT	REV
					FINISH 仕上げ	10 UNDER 未満	±0.2	DRAWN BY & DATE S. Akiyama 01/01/25	TITLE: COMPACT ROBOT CONN. (CRC) PLUG PIN HS'G			
					WIRE RANGE 適用電線範囲	10 OVER 30 UNDER 未満	±0.25	CHECKED BY & DATE J. Miyazawa / Y. Ito				
					INS. RANGE 被覆外径	30 OVER 以上	±0.3	APPROVED BY & DATE S. Akiyama	MOLEX			
						ANGLE 角度	±3°	CAD FILE NAME 51234004.S01	MATERIAL NO. SEE CHART	DRAWING NO. SD-51234-004	SHEET NO. 1 OF 1	SIZE B
THIS DRAWING CONTAINS INFORMATION THAT IS PROPRIETARY TO MOLEX INCORPORATED AND SHOULD NOT BE USED WITHOUT WRITTEN PERMISSION.												