

*New!*

# C&K KDS Series Intrusion Switches

## Features/Benefits

- Slot mount into chassis to reduce installation cost
- Wire harness length & connector easily customized
- Available in N.O. or N.C. configuration

## Typical Applications

- Intrusion/Alarm switch in network desktop PC
- Intrusion/Alarm switch in telecommunication equipment
- Intrusion/Alarm switch in cellular base station

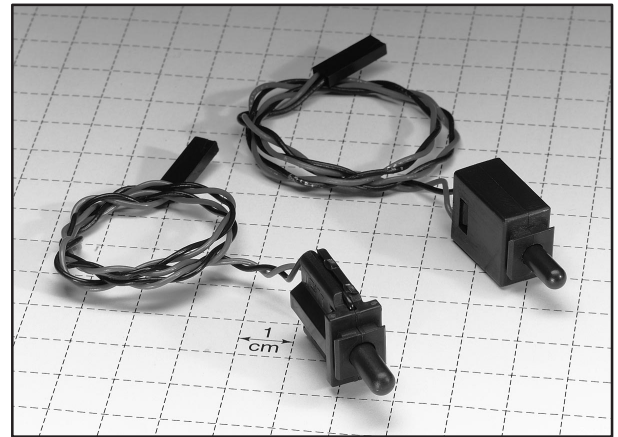

## How To Order

Complete part numbers for KDS Series Switches are shown below.

## Specifications

CONTACT RATING: 0.4 VA max. @ 20 V AC or DC.  
 MECHANICAL & ELECTRICAL LIFE: 10,000 actuations min. at full load.  
 CONTACT RESISTANCE: 200 milliohms max. initial @ 2-4 V DC, 100mA.  
 INSULATION RESISTANCE:  $10^9$  ohms min.  
 OPERATING TEMPERATURE:  $-30^{\circ}\text{C}$  to  $+85^{\circ}\text{C}$   
 TRAVEL: Pretravel: 0.050" max. Overtravel:  $0.375 \pm .025$ "  
 DIELECTRIC STRENGTH: 500 V RMS min. @ sea level.  
 PACKAGING: Bulk packaging.

## Materials

HOUSING: Nylon 6/6 (UL 94V-0)  
 ACTUATOR: Nylon 6/6 (UL 94V-0)  
 MOVABLE CONTACT: Copper alloy, gold plate over nickel plate.  
 FIXED CONTACT: Brass, gold plate over nickel plate.  
 WIRE: UL 1061-24 AWG.  
 CONNECTOR HOUSING: AMP #103688-1 or equivalent.  
 CONNECTOR TERMINAL: AMP #104480-2 or equivalent.

**NOTE:** Specifications and materials listed above are for switches with standard options. For information on specific and custom switches, consult Customer Service Center.

PART NUMBER	'L' LEAD LENGTH (IN)	SWITCH FUNCTION		SCHEMATIC
		POS. 1	POS. 2	
KDS1102RSWC12CB	12	OFF	MOM.	
KDS1102RSWC16CB	16.5	OFF	MOM.	SPST N.O.
KDS3302RSWC12CB	12	ON	MOM.	
KDS3302RSWC16CB	16.5	ON	MOM.	SPST N.C.

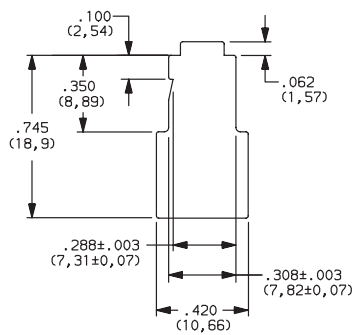

PANEL CUTOUT  
(THICKNESS .040 .003)

