

THIS DOCUMENT IS THE PROPERTY OF  
KEYSTONE ELECTRONICS CORP. AND  
SHALL NOT BE REPRODUCED, DISTRIBUTED  
OR USED AS A BASIS FOR MANUFACTURE  
WITHOUT PRIOR WRITTEN PERMISSION  
FROM KEYSTONE ELECTRONICS CORP.

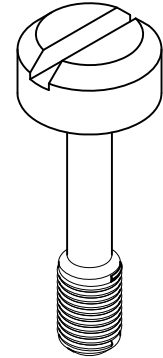
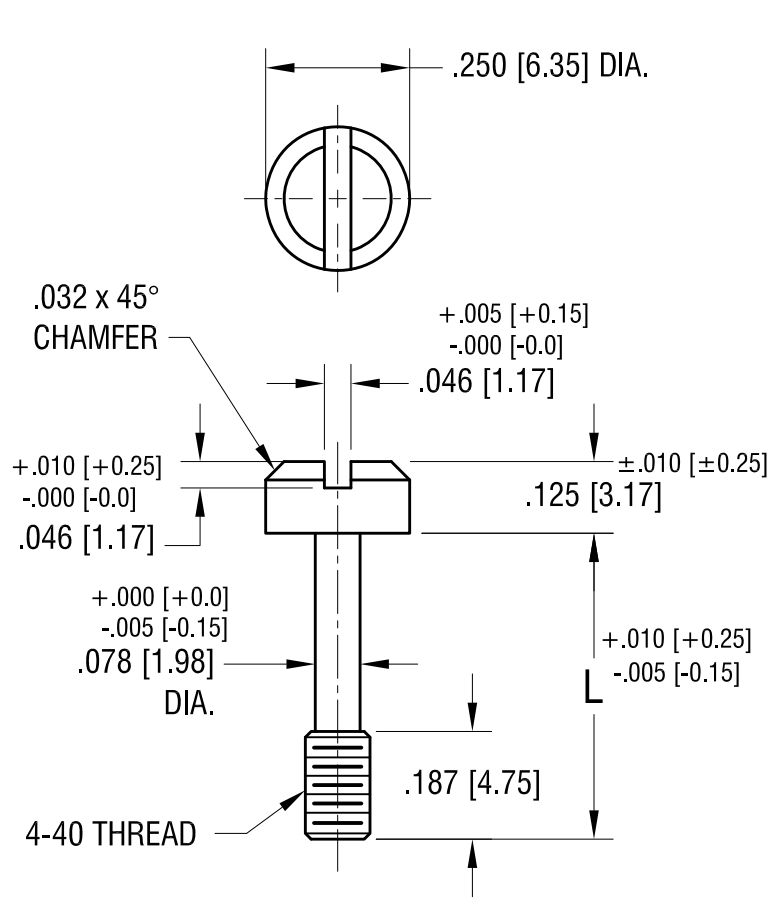

PART NO.	'L' DIM.
2413	.469 [11.91]
2414	.531 [13.49]

DATE	DESCRIPTION	REV.
12.17.10	CHANGE AS PER ECN 10-089	C
7.15.08	CHANGE AS PER ECN 08-123	B
3.27.08	CHANGE AS PER ECN 08-098	A

KEYSTONE ELECTRONICS CORP.			
ASTORIA, N.Y. 11105-2017			
PART NAME		CAPTIVE SCREW	
MATERIAL		STAINLESS STEEL	
FINISH	-	DRN BY	BOONE
		APP'D	LN
		DATE	12.5.95
		SCALE	3X
TOLERANCES	INCH [MM]	CODE	DWG NO.
DECIMAL	± .005 [± 0.15]	C/M	2413-2414
ANGULAR	± 1°		
UNLESS OTHERWISE SPECIFIED			