

LOADING PATTERN MATING SIDE

f											0	0	0	0	0	0	0	0	0	0	0
e											4	4	5	4	4	4	5	5	5	5	5
d											4	4	5	4	4	5	5	5	5	5	5
c											4	4	5	4	4	5	5	5	5	5	5
b											4	4	5	4	4	5	5	5	5	5	5
a											4	4	5	4	4	5	5	5	5	5	5
z											4	4	5	4	4	5	5	5	5	5	5
POS	0	1	0	5	1	0	5	1	5	2	0	5	2	5							

LOADED CONNECTOR ASSEMBLY  
(FOR EXAMPLE)

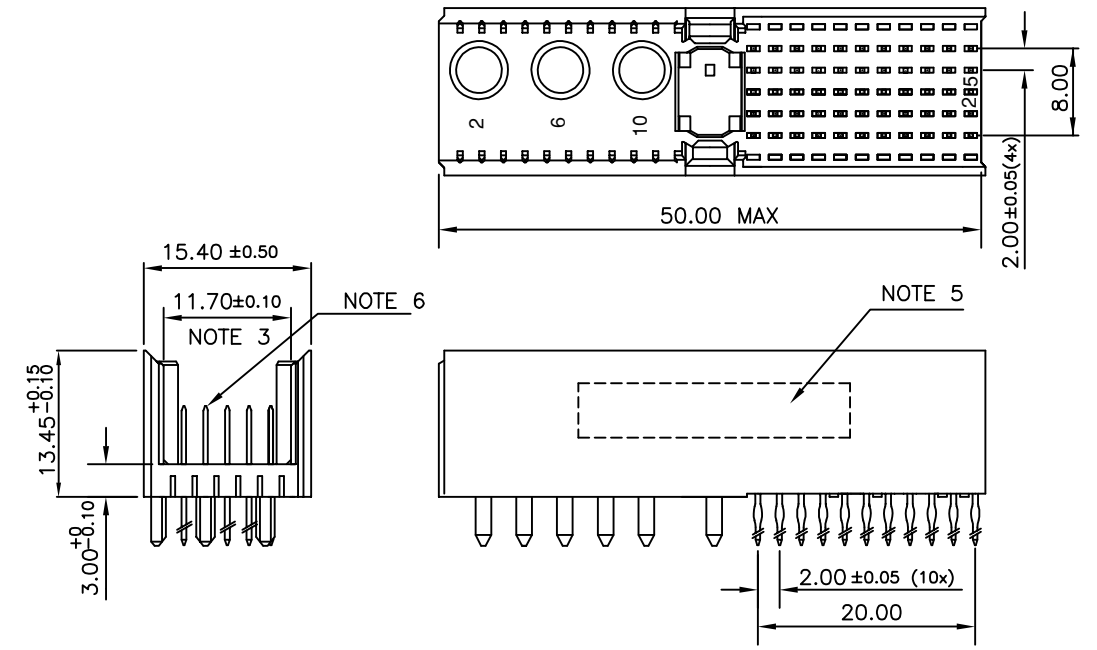

CONTACT OVERVIEW

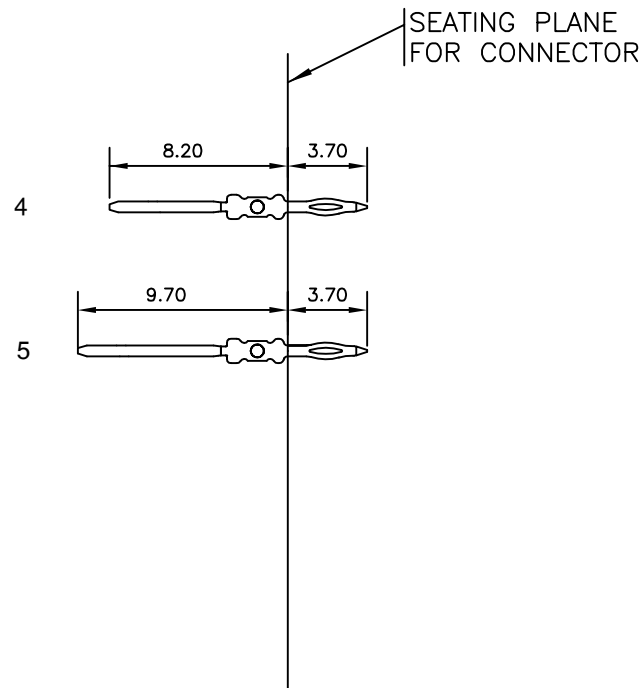

LAY-OUT P.C.B.-HOLE

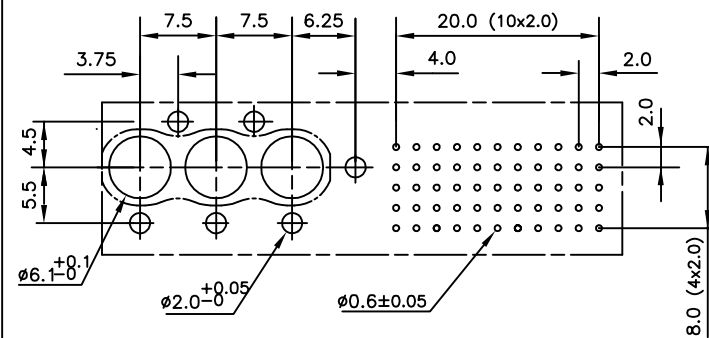

HM2P11PDG3J5 LEAD FREE INDICATOR : LF = LEAD FREE (DIGIT 15 & 16)  
PLATING CODE (DIGIT 13 AND 14)  
(REF DRW NO. BS,C , 201844 , 003)

**NOTES**

- THIS PRODUCT IS CSA APPROVED.
  - THIS PRODUCT IS UL RECOGNIZED.
  - MEASURED AT THE BOTTOM.
  - MATERIAL CONTACT: PHOSPHORBRONZE  
HOUSING: CREAM WHITE GLASS FILLED POLYESTER UL-94V0
  - CONNECTOR PRINTED WITH P/N AND DATE CODE.
  - FOR ACTUAL CONTACT LOADINGS, SEE LOADING PATTERN MATING SIDE.
  - SHAPE OF CONNECTOR HOUSING CAN ALTER DEPENDING ON PRODUCTION LOCATION
  - THE PRODUCT (LF) MEETS EUROPEAN UNION DIRECTIVES AND OTHER COUNTRY REGULATIONS AS DESCRIBED IN GS-22-008
  - FOR RECOMMENDED PTH DIMENSIONS REFER DRAWING : BS, A , 201572 , 001
- CATALOG NO: HM2P11PDG3J5----

mat'l. code SEE NOTE 4		surface ISO 1302 ✓		tolerance ISO 406 ISO 1101		projection MM		product family MILLIPACS			
litr		ecn no		dr		date		tolerances unless otherwise specified		title	
A		105-0102		MINI		2005-06-16		.0±0.2		MPACS 5+2R STR HDR PF CONN TYPE M	
B		106-0099		MINI		2006-07-12		.00±0.1			
				angles		linear		0°±1°		scale -	
				dr		MINI K VANDANATH		2005-06-16		dwg no sheet 1 of 1 size	
				enr		BIJU K PAUL		2005-06-16		BS, C ,203028,264 A3	
				chr		BIJU K PAUL		2006-07-12		type Product Customer Drawing	
				appd		BIJU K PAUL		2006-07-12			
sheet index		revision sheet		B		1					



Copyright FCI