

## Surface Mount Schottky Barrier Rectifiers

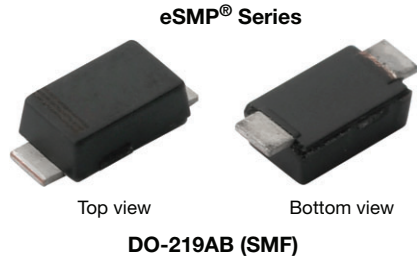

AUTOMOTIVE  
GRADE  
Available



**RoHS**  
COMPLIANT  
HALOGEN  
**FREE**

### FEATURES

- Low profile package
- Ideal for automated placement
- Low forward voltage drop, low power losses
- Meets MSL level 1, per J-STD-020, LF maximum peak of 260 °C
- Wave and reflow solderable
- AEC-Q101 qualified available  
- Automotive ordering code: base P/NHM3
- Material categorization: for definitions of compliance please see [www.vishay.com/doc?99912](http://www.vishay.com/doc?99912)

### TYPICAL APPLICATIONS

For use in high frequency inverters, freewheeling, DC/DC converters, and polarity protection in commercial, industrial, and automotive applications.

### MECHANICAL DATA

**Case:** DO-219AB (SMF)

Molding compound meets UL 94 V-0 flammability rating

Base P/N-M3 - halogen-free, RoHS-compliant

Base P/NHM3 - halogen-free, RoHS-compliant, and AEC-Q101 qualified

**Terminals:** Matte tin plated leads, solderable per J-STD-002 and JESD 22-B102

M3 and HM3 suffix meets JESD 201 class 2 whisker test

**Polarity:** Color band denotes the cathode end

| PRIMARY CHARACTERISTICS                  |                |
|--|----------------|
| $I_{F(AV)}$                              | 1.0 A          |
| $V_{RRM}$                                | 40 V           |
| $I_{FSM}$                                | 40 A           |
| $V_F$ at $I_F = 1.0$ A ( $T_A = 125$ °C) | 0.37 V         |
| $T_J$ max. (AC mode)                     | 150 °C         |
| $T_J$ max. (DC forward current)          | 175 °C         |
| Package                                  | DO-219AB (SMF) |
| Diode variations                         | Single die     |

| MAXIMUM RATINGS ( $T_A = 25$ °C unless otherwise noted)                      |                   |             |      |
|--|-------------------|-------------|------|
| PARAMETER  | SYMBOL            | SS1F4       | UNIT |
| Device marking code  |                   | 14          |      |
| Maximum repetitive peak reverse voltage                                      | $V_{RRM}$         | 40          | V    |
| Maximum average forward rectified current (fig.1)                            | $I_{F(AV)}^{(1)}$ | 1.0         | A    |
| Peak forward surge current 8.3 ms single half sine-wave $T_J$ (init) = 25 °C | $I_{FSM}$         | 40          | A    |
| Operating junction and storage temperature range                             | $T_J, T_{STG}$    | -55 to +150 | °C   |
| Junction temperature in DC forward current without reverse bias              | $T_J$             | 175         | °C   |

#### Note

(1) Free air, mounted on recommended copper pad area



| ELECTRICAL CHARACTERISTICS ( $T_A = 25\text{ }^\circ\text{C}$ unless otherwise noted) |                      |                                   |             |      |      |               |
|---|----------------------|-----------------------------------|-------------|------|------|---------------|
| PARAMETER   | TEST CONDITIONS      |                                   | SYMBOL      | TYP. | MAX. | UNIT          |
| Instantaneous forward voltage   | $I_F = 0.7\text{ A}$ | $T_A = 25\text{ }^\circ\text{C}$  | $V_F^{(1)}$ | 0.43 | -    | V             |
|   | $I_F = 1.0\text{ A}$ |                                   |             | 0.46 | 0.52 |               |
|   | $I_F = 0.7\text{ A}$ | $T_A = 125\text{ }^\circ\text{C}$ |             | 0.33 | -    |               |
|   | $I_F = 1.0\text{ A}$ |                                   |             | 0.37 | 0.43 |               |
| Reverse current   | $V_R = 40\text{ V}$  | $T_A = 25\text{ }^\circ\text{C}$  | $I_R^{(2)}$ | -    | 150  | $\mu\text{A}$ |
|   |                      | $T_A = 125\text{ }^\circ\text{C}$ |             | 7    | 25   | mA            |
| Typical junction capacitance  | 4.0 V, 1 MHz         |                                   | $C_J$       | 85   | -    | pF            |

**Notes**

- (1) Pulse test: 300  $\mu\text{s}$  pulse width, 1 % duty cycle  
(2) Pulse test: Pulse width  $\leq 5\text{ ms}$

| THERMAL CHARACTERISTICS ( $T_A = 25\text{ }^\circ\text{C}$ unless otherwise noted) |                             |       |                    |
|--|-----------------------------|-------|--------------------|
| PARAMETER  | SYMBOL                      | SS1F4 | UNIT               |
| Typical thermal resistance   | $R_{\theta JA}^{(1)(2)(3)}$ | 125   | $^\circ\text{C/W}$ |
|  | $R_{\theta JM}^{(2)(3)}$    | 16.5  |                    |

**Notes**

- (1) The heat generated must be less than the thermal conductivity from junction-to-ambient:  $dP_D/dT_J < 1/R_{\theta JA}$   
(2) Device mounted on FR4 PCB, 2 oz. standard footprint  
(3) Thermal resistance  $R_{\theta JA}$  - junction to ambient;  $R_{\theta JM}$  - junction to mount

| ORDERING INFORMATION (Example) |                 |                        |               |                                    |
|--------------------------------|-----------------|------------------------|---------------|------------------------------------|
| PREFERRED P/N                  | UNIT WEIGHT (g) | PREFERRED PACKAGE CODE | BASE QUANTITY | DELIVERY MODE                      |
| SS1F4-M3/H                     | 0.015           | H                      | 3000          | 7" diameter plastic tape and reel  |
| SS1F4-M3/I                     | 0.015           | I                      | 10 000        | 13" diameter plastic tape and reel |
| SS1F4HM3/H <sup>(1)</sup>      | 0.015           | H                      | 3000          | 7" diameter plastic tape and reel  |
| SS1F4HM3/I <sup>(1)</sup>      | 0.015           | I                      | 10 000        | 13" diameter plastic tape and reel |

**Note**

- (1) AEC-Q101 qualified

**RATINGS AND CHARACTERISTICS CURVES** ( $T_A = 25\text{ }^\circ\text{C}$  unless otherwise noted)

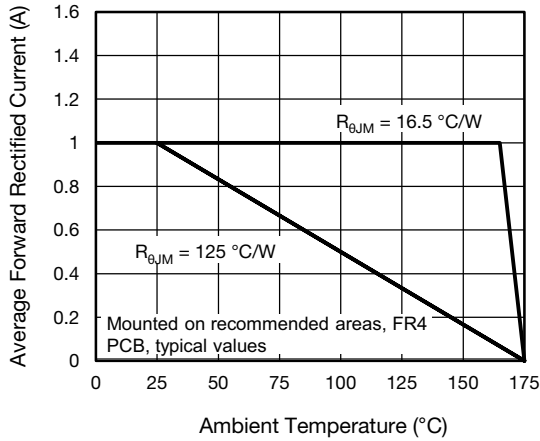

Fig. 1 - Maximum Forward Current Derating Curve

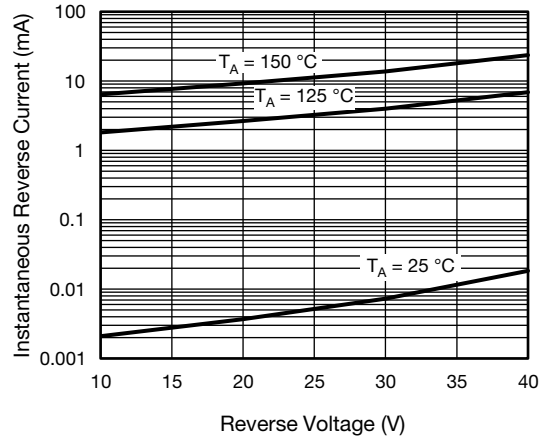

Fig. 4 - Typical Reverse Leakage Characteristics

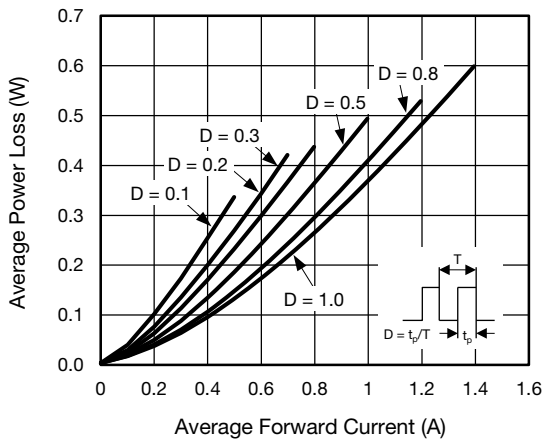

Fig. 2 - Average Power Loss Characteristics

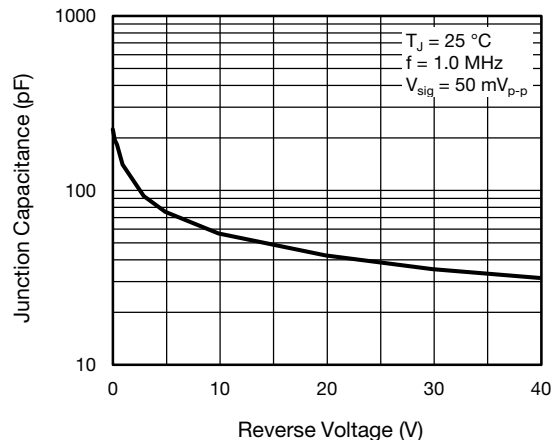

Fig. 5 - Typical Junction Capacitance

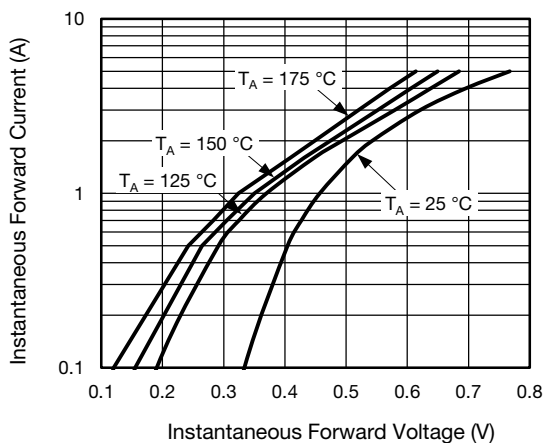

Fig. 3 - Typical Instantaneous Forward Characteristics

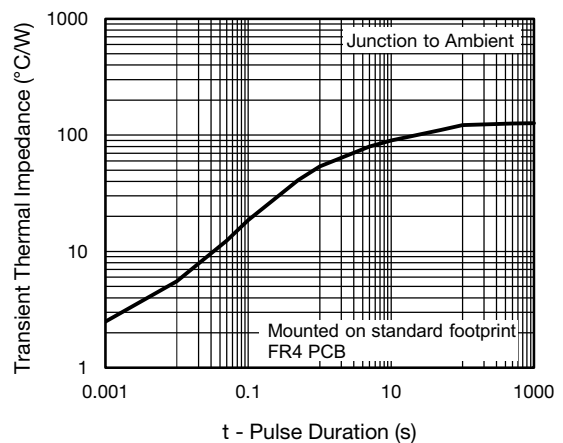
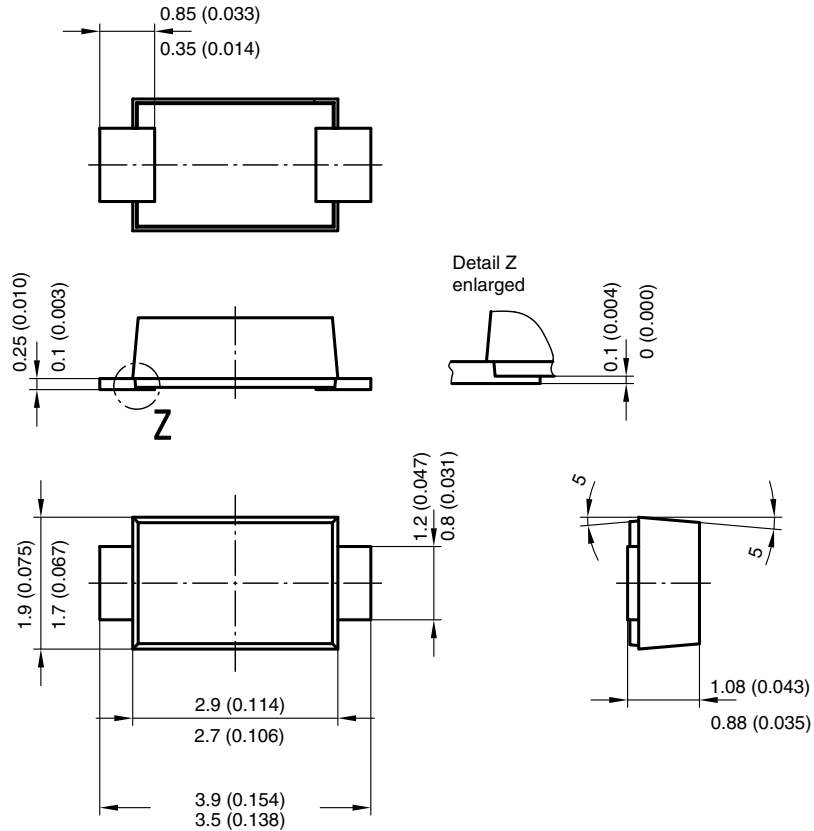

Fig. 6 - Typical Transient Thermal Impedance



PACKAGE OUTLINE DIMENSIONS in millimeters (inches)



Foot print recommendation:

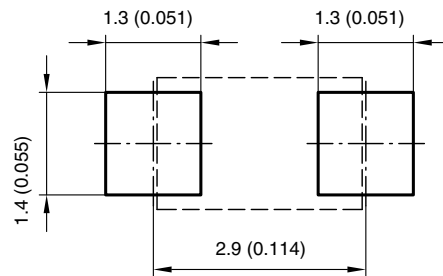

Created - Date: 15. February 2005  
 Rev. 3 - Date: 13. March 2007  
 Document no.: S8-V-3915.01-001 (4)  
 17247

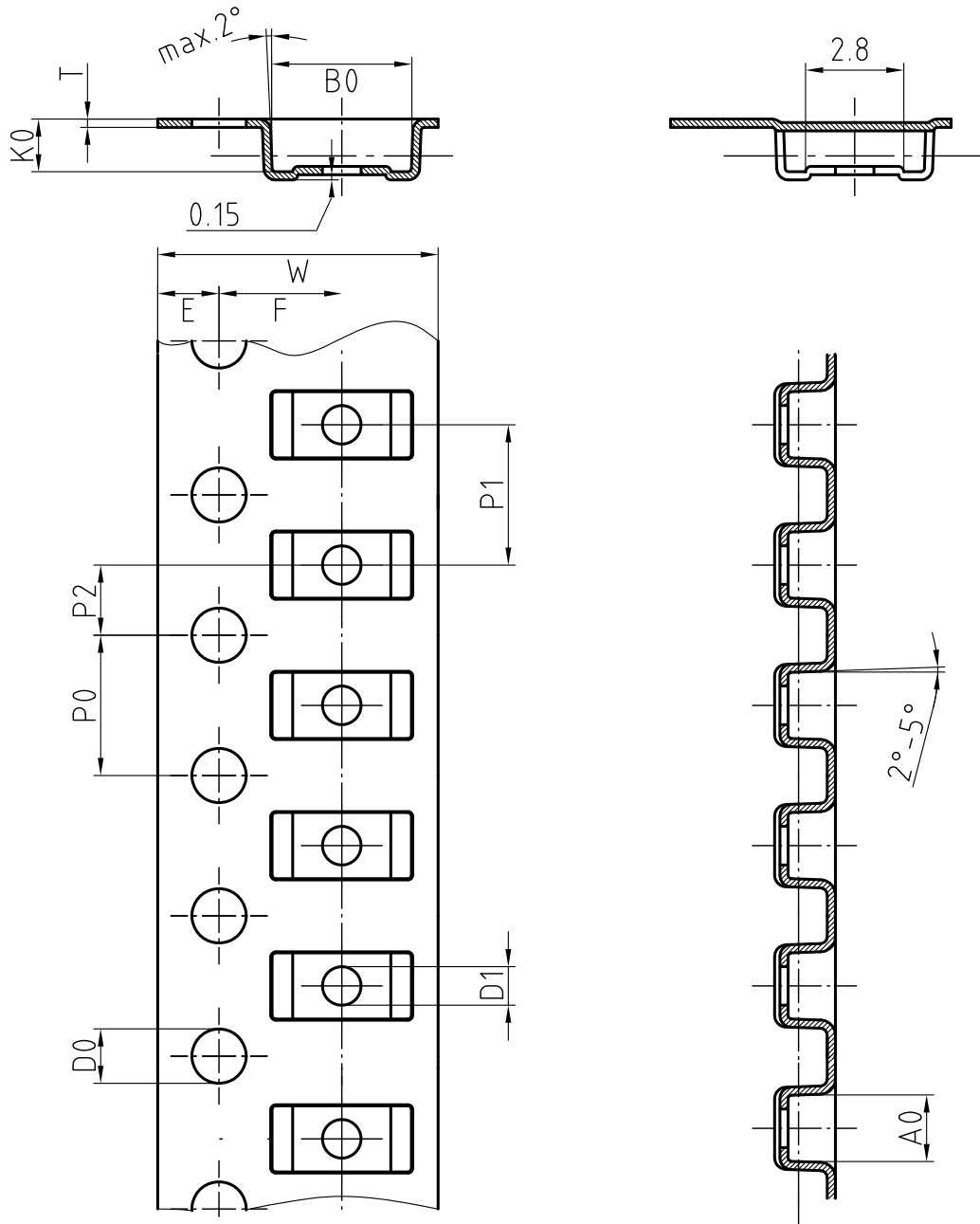
**BLISTERTAPE DIMENSIONS** in millimeters: **DO-219AB (SMF)**

| Mat: | A0  | B0  | K0  | W   | T     | P0  | P2  | P1  | D0  | D1 | E    | F   |
|------|-----|-----|-----|-----|-------|-----|-----|-----|-----|----|------|-----|
| PS   | 1.9 | 4.0 | 1.5 | 8.0 | 0.235 | 4.0 | 2.0 | 4.0 | 1.5 | 1  | 1.75 | 3.5 |

Document-No.: S8-V-3717.02-001 (3)

18513



## Disclaimer

ALL PRODUCT, PRODUCT SPECIFICATIONS AND DATA ARE SUBJECT TO CHANGE WITHOUT NOTICE TO IMPROVE RELIABILITY, FUNCTION OR DESIGN OR OTHERWISE.

Vishay Intertechnology, Inc., its affiliates, agents, and employees, and all persons acting on its or their behalf (collectively, "Vishay"), disclaim any and all liability for any errors, inaccuracies or incompleteness contained in any datasheet or in any other disclosure relating to any product.

Vishay makes no warranty, representation or guarantee regarding the suitability of the products for any particular purpose or the continuing production of any product. To the maximum extent permitted by applicable law, Vishay disclaims (i) any and all liability arising out of the application or use of any product, (ii) any and all liability, including without limitation special, consequential or incidental damages, and (iii) any and all implied warranties, including warranties of fitness for particular purpose, non-infringement and merchantability.

Statements regarding the suitability of products for certain types of applications are based on Vishay's knowledge of typical requirements that are often placed on Vishay products in generic applications. Such statements are not binding statements about the suitability of products for a particular application. It is the customer's responsibility to validate that a particular product with the properties described in the product specification is suitable for use in a particular application. Parameters provided in datasheets and / or specifications may vary in different applications and performance may vary over time. All operating parameters, including typical parameters, must be validated for each customer application by the customer's technical experts. Product specifications do not expand or otherwise modify Vishay's terms and conditions of purchase, including but not limited to the warranty expressed therein.

Except as expressly indicated in writing, Vishay products are not designed for use in medical, life-saving, or life-sustaining applications or for any other application in which the failure of the Vishay product could result in personal injury or death. Customers using or selling Vishay products not expressly indicated for use in such applications do so at their own risk. Please contact authorized Vishay personnel to obtain written terms and conditions regarding products designed for such applications.

No license, express or implied, by estoppel or otherwise, to any intellectual property rights is granted by this document or by any conduct of Vishay. Product names and markings noted herein may be trademarks of their respective owners.