

PRODUCT NO.

SEE TABLE

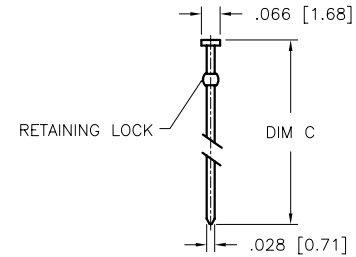
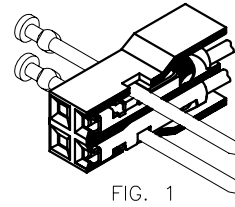
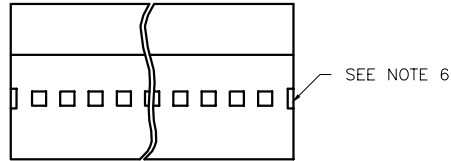

FIG. 2  
RETENTION ROD DETAIL  
SCALE 4:1 NOTE 7

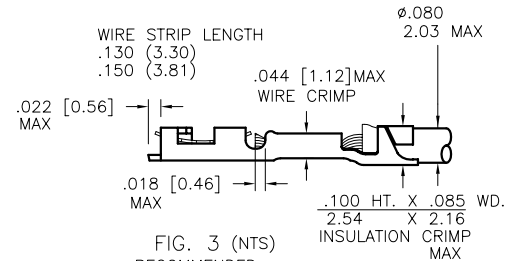
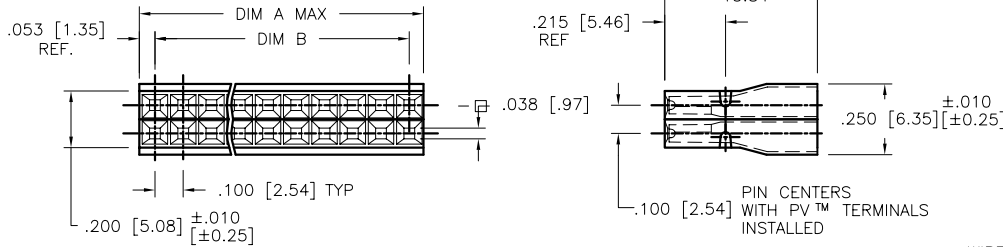

FIG. 3 (NTS)  
RECOMMENDED  
CRIMP INFORMATION

NOTES:

- ① HOUSING MATERIAL: MODIFIED POLYPHENYLENE ETHER, FLAME RETARDANT PER UL-94V-0, COLOR: BLACK.
- ② ROD MATERIAL: NYLON (NATURAL) SEE FIGURE #2 FOR DIMENSIONS.
- ③ TO MAKE PROPER CONTACT, ALL MALE PINS FOR EACH HOUSING MUST BE WITHIN  $\pm 0.015/\pm 0.38$  IN LENGTH. MIN. PIN LENGTH IS .180/4.57.
- ④ MAX WIRE CRIMP AND WIRE STRANDS ARE SHOWN IN FIGURE 3. SEE MINI PV™ TERMINAL SPECIFICATION TA-210 FOR CORRECT CRIMP HEIGHT FOR EACH DIFFERENT WIRE. PRODUCT SPECIFICATION: BUS-12-067.
- ⑤ THIS HOUSING IS INTENDED FOR USE WITH MINI PV™ TERMINAL WITH 18 AWG WIRE MEETING SPECIFICATIONS SHOWN FIGURE 3.
- ⑥ HEAD RELIEF MAY OCCUR AT EITHER END OR MAY NOT OCCUR AT ALL. (WHEN NO HEAD RELIEF APPEARS, A .030/0.76 MAX ROD PROTRUSION WILL APPLY).
- ⑦ RETENTION RODS ARE INCLUDED WITH ROD HOUSINGS. RODS ARE TO BE TRIMMED AFETR INSERTION.
- ⑧ PRODUCT MEETS EUROPEAN UNION DIRECTIVES AND OTHER COUNTRY REGULATIONS AS DESCRIBED IN GS-22-008.
- ⑨ THIS PRODUCT IS NOT INTENDED TO BE EXPOSED TO MANUFACTURING SOLDER PROCESSES.

mat'l. code SEE NOTE 1 & 2				surface <input checked="" type="checkbox"/>		tolerance		projection <input checked="" type="checkbox"/>		product family PV HOUSINGS	
ltr	ec'n no	dr	date	tolerances unless otherwise specified				title		MINI ROD HSG DR .100 [2.54]CC LARGE INSULATION WITH RODS	
D	v51436	SAR	1996-02-01	angles	linear	.XX+01/XX+3		INCH/MM		sheet 1 of 2	
E	v70956	HTB	1997-06-24			.XXX+005/XXX+13		scale 2:1		size A3	
F	v90988	RGD	1999-06-23	0'±2'		.XXXX+0020/XXX+051				dwg no 65469	
G	v05-0713	DAI	2005-07-29	dr	S. ROYER	1996-02-01		FCJ		type Product Customer Drawing	
H	v06-0448	HTB	2006-05-22	engr	T. HANNA	1996-02-01					
J	v07-0563	HTB	2007-08-27	chr	T. BREWBAKER	1996-02-01					
				appd	T. HANNA	1996-02-01					
sheet	revision	J	J								
index	sheet	1	2								

PRODUCT NUMBER	NO.OF CAV.	DIM A MAX.	DIM B MAX.	SPECIAL MARKINGS	CUSTOMER REQUEST	RETENTION ROD P/N	QTY	DIM"C" FIG.2
65469-001LF	4	.225 [5.71]	.100 [2.54]			65048-040	2	1.30 [33.0]
65469-002LF	6	.325 [8.26]	.200 [5.08]			65048-040	2	1.30 [33.0]
65469-003LF	8	.425 [10.80]	.300 [7.62]			65048-040	2	1.30 [33.0]
65469-004LF	10	.525 [13.34]	.400 [10.16]			65048-040	2	1.30 [33.0]
65469-005LF	12	.625 [15.88]	.500 [12.70]			65048-040	2	1.30 [33.0]
65469-006LF	14	.725 [18.42]	.600 [15.24]			65048-040	2	1.30 [33.0]
65469-007LF	16	.825 [20.96]	.700 [17.78]			65048-040	2	1.30 [33.0]
65469-008LF	18	.925 [23.50]	.800 [20.32]			65048-040	2	1.30 [33.0]
65469-009LF	20	1.025 [26.04]	.900 [22.86]			65048-026	2	2.30 [58.4]
65469-010LF	22	1.125 [28.58]	1.000 [25.40]			65048-026	2	2.30 [58.4]
65469-011LF	24	1.225 [31.12]	1.100 [27.94]			65048-026	2	2.30 [58.4]
65469-012LF	26	1.325 [33.66]	1.200 [30.48]			65048-026	2	2.30 [58.4]
65469-013LF	28	1.425 [36.20]	1.300 [33.02]			65048-026	2	2.30 [58.4]
65469-014LF	30	1.525 [38.74]	1.400 [35.56]			65048-026	2	2.30 [58.4]
65469-015LF	32	1.625 [41.28]	1.500 [38.10]			65048-026	2	2.30 [58.4]
65469-016LF	34	1.725 [43.82]	1.600 [40.64]			65048-026	2	2.30 [58.4]
65469-017LF	36	1.825 [46.36]	1.700 [43.18]			65048-026	2	2.30 [58.4]
65469-018LF	38	1.925 [48.90]	1.800 [45.72]			65048-026	2	2.30 [58.4]
65469-019LF	40	2.025 [51.44]	1.900 [48.26]			65048-013	2	3.45 [87.6]
65469-020LF	10	.525 [13.34]	.400 [10.16]	STYLE "A"	* XEROX	65048-040	2	1.30 [33.0]
65469-021LF	12	.625 [15.88]	.500 [12.70]	STYLE "A"	* XEROX	65048-040	2	1.30 [33.0]
65469-022LF	20	1.025 [26.04]	.900 [22.86]	STYLE "A"	XEROX	65048-026	2	2.30 [58.4]
65469-023LF	26	1.325 [33.66]	1.200 [30.48]	STYLE "A"	XEROX	65048-026	2	2.30 [58.4]
65469-024LF	32	1.625 [41.28]	1.500 [38.10]	STYLE "A"	XEROX	65048-026	2	2.30 [58.4]
65469-025LF	34	1.725 [43.82]	1.600 [40.64]	STYLE "A"	XEROX	65048-026	2	2.30 [58.4]
65469-026LF	40	2.025 [51.44]	1.900 [48.26]	STYLE "A"	XEROX	65048-013	2	2.30 [58.4]

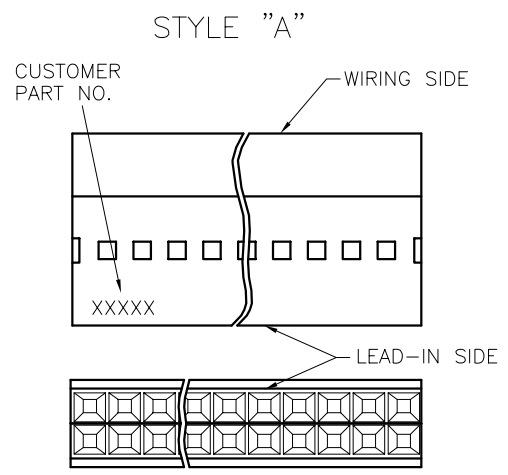

LOGO, CUSTOMER PART NO. AND FIRST AND LAST CAVITIES OF A ROW AS WELL AS, EVERY FOURTH CAVITY BETWEEN SHALL BE MARKED AS SHOWN.

\* NOTE: LOGO MUST NOT APPEAR ON THESE HOUSINGS SO THAT THE COMPLETE PART NO. MAY BE INCLUDED.



FCconnect.com

Copyright FCJ

mat'l. code SEE NOTE 1 & 2				surface <input checked="" type="checkbox"/> tolerance		projection		product family PV HOUSINGS	
ltr	ecr no	dr	date	tolerances unless otherwise specified		INCH/MM		title	
J				angles	linear	.XX+01/XX-3 XXX+005/XXX-13 XXXX+0020/XXX+051		MINI ROD HSG DR .100 [2.54]CC LARGE INSULATION WITH RODS	
				0'±2"		scale 2:1		dwg no 65469	
				dr	S. ROYER	1996-02-01		sheet 2 of 2 size A3	
				engr	T. HANNA	1996-02-01		type Product Customer Drawing	
				chr	T. BREWBAKER	1996-02-01			
				appd	T. HANNA	1996-02-01			
sheet index	revision sheet								