

THIS DRAWING IS UNPUBLISHED.

RELEASED FOR PUBLICATION

© COPYRIGHT - By -

ALL RIGHTS RESERVED.

LOC FT DIST 0

REVISIONS

P	LTR	DESCRIPTION	DATE	DWN	APVD
	A	REVISED PER ECO-11-023039	23FEB12	KH	DR

NOTES:

MECHANICAL:

HOUSING: THERMOPLASTIC, UL94V-2, BLACK.  
 TERMINALS: BRASS, BRIGHT TIN PLATE.  
 SCREWS: 6-32, STEEL, PLATED .0002 MIN ZINC W/  
 CLEAR CHROMATE COATING. UNLESS OTHERWISE  
 SPECIFIED.  
 TIGHTENING TORQUE: 8 IN-LB.

ELECTRICAL:

MAXIMUM CURRENT: 20A.  
 OPERATING VOLTAGE: 600V  
 WIRE RANGE: 12-22 AWG

ENVIRONMENTAL:

OPERATING TEMP.: -60°C TO 105°C

- 1 SEE FIGURE.
- 2 SCREWS ARE NICKEL PLATED BRASS.
- 3 PRELIMINARY PART NUMBER.
- 4 ALL SCREWS BOTTOMED, TORQUE 2 TO 4 IN-LBS

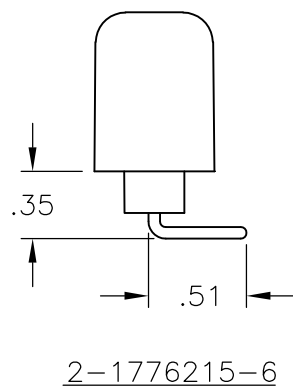
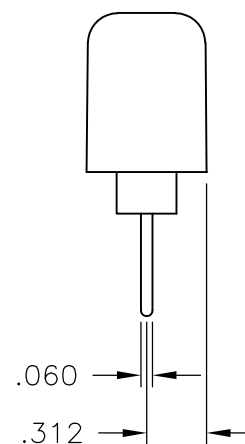
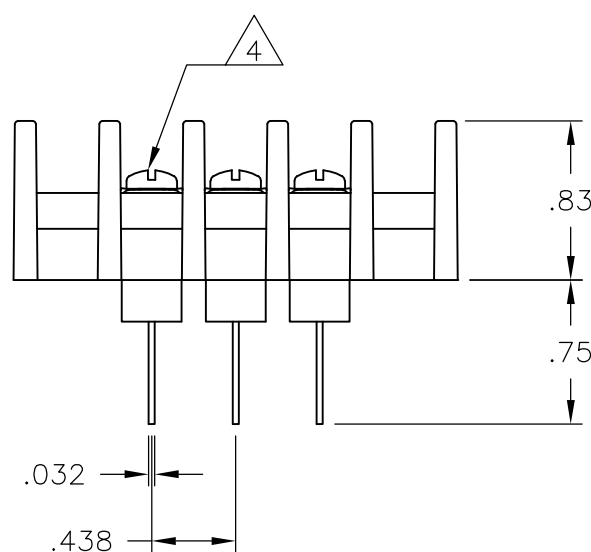
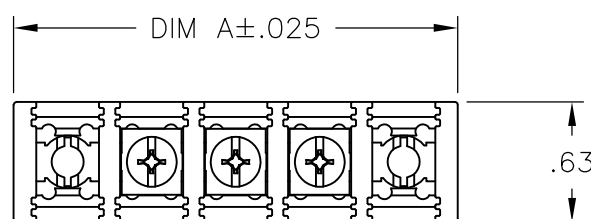

DIM A	NO. OF POS.	CATALOG NUMBER	PART NUMBER
11.937	25	SSB7TM250701	2-1776215-5
11.500	24	SSB7TM240701	2-1776215-4
11.062	23	SSB7TM230701	2-1776215-3
10.625	22	SSB7TM220701	2-1776215-2
10.187	21	SSB7TM210701	2-1776215-1
9.750	20	SSB7TM200701	2-1776215-0
9.312	19	SSB7TM190701	1-1776215-9
8.875	18	SSB7TM180701	1-1776215-8
8.437	17	SSB7TM170701	1-1776215-7
8.000	16	SSB7TM160701	1-1776215-6
7.562	15	SSB7TM150701	1-1776215-5
7.125	14	SSB7TM140701	1-1776215-4
6.687	13	SSB7TM130701	1-1776215-3
6.250	12	SSB7TM120701	1-1776215-2
5.812	11	SSB7TM110701	1-1776215-1
5.375	10	SSB7TM100701	1-1776215-0
4.937	9	SSB7TM090701	1776215-9
4.500	8	SSB7TM080701	1776215-8
4.062	7	SSB7TM070701	1776215-7
3.625	6	SSB7TM060701	1776215-6
3.187	5	SSB7TM050701	1776215-5
2.750	4	SSB7TM041504	2-1776215-6
2.750	4	SSB7TM040701	1776215-4
2.312	3	SSB7TM030701	1776215-3
1.875	2	SSB7TM020701	1776215-2
1.437	1	SSB7TM010701	1776215-1

THIS DRAWING IS A CONTROLLED DOCUMENT.		DWN S SCHL GEL 9/27/04	<b>STE</b> TE Connectivity		
DIMENSIONS: INCHES		CHK S YODER 9/27/04			
TOLERANCES UNLESS OTHERWISE SPECIFIED:		APVD S YODER 9/27/04	NAME		
0 PLC ± -	1 PLC ± -	PRODUCT SPEC	SSB7TMXX0701		
2 PLC ± .02	3 PLC ± .010	APPLICATION SPEC	SIZE	CAGE CODE	DRAWING NO
4 PLC ± -	ANGLES ± 1°	WEIGHT -	A3	00779	C-1776215
MATERIAL -	FINISH -	CUSTOMER DRAWING		SCALE NTS	SHEET 1 OF 1
				RESTRICTED TO -	REV A