

This document is the property of Amphenol Corporation and is delivered on the express condition that it is not to be disclosed, reproduced or used, in whole or in part, for manufacture or sale by anyone other than Amphenol Corporation without its prior consent, and that no right is granted to disclose or to use any information in this document.

The marking on this product doesn't contain environmental hazardous materials per Material Specification SS-00259 for Sony GP compliant or per directive 2011/65/EU for RoHS compliant.



ORIGINAL

| REVISIONS | | | | |
|-----------|----------|-----------------------------------------------|------------|-----------|
| SYM | ECN No. | DESCRIPTION | DATE | APPROVED |
| A | NE-14096 | RELEASE TO PRODUCTION | 05/21/2014 | Arron Lin |
| B | NE-15016 | COMBINE DRAWING FOR PACKAGE AND TAIL OPTIONS. | 02/02/2015 | Arron Lin |

NOTES:

- MATERIAL:
HOUSING: HIGH TEMPERATURE THERMAL PLASTIC, LCP, UL94V-0, COLOR: BLACK.
TERMINAL: HIGH PERFORMANCE COPPER ALLOY.
- FINISH:
TERMINAL:
CONTACT AREA: SELECTIVE PLATING.;
SOLDERING AREA: MATTE TIN PLATING 100 μ" THICKNESS MIN.;
UNDER PLATING: NICKEL PLATING 50 μ" THICKNESS MIN. OVERALL.
- PACKING IS PER AMTA PACKING SPECIFICATION PKS-0001.
- THIS PRODUCT DOESN'T CONTAIN ENVIRONMENTAL HAZARDOUS PER DIRECTIVE 2011/65/EU FOR RoHS COMPLIANT.
- PRODUCT SPECIFICATION REFER TO : PS-7528
- TO ENSURE CURRENT RATING CAPABILITY, PLEASE ADOPT TOTAL SOLUTION. (G88MPH CABLE HOUSING SERIES WITH G88MPC CABLE TERMINAL SERIES)

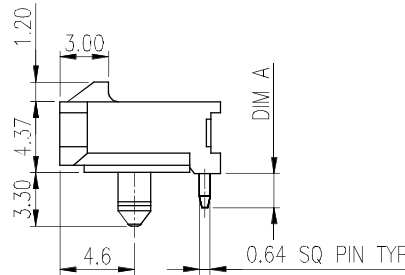
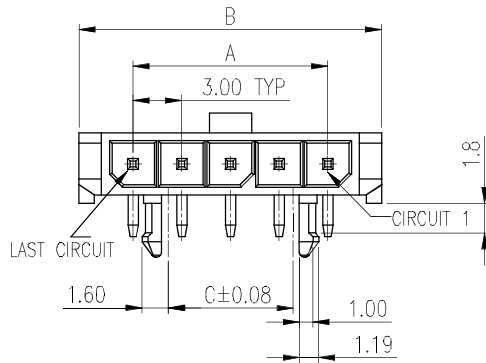
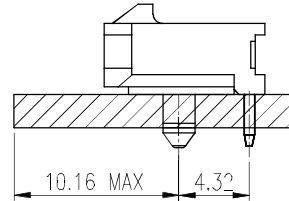
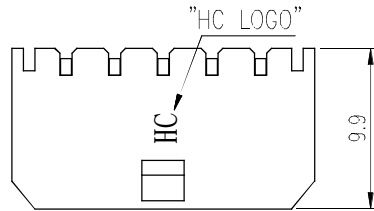

PART NO. G88MPBXX0X2XXEU

No. OF CIRCUIT ——— DIM A /PACKING OPTIONS

- C1: 2.10mm(TRAY)
- C : 3.20mm(TRAY)
- 1R: 2.10mm(T&R)
- 2R: 3.20mm(T&R)

CONTACT FINISH

- 0: MATTE TIN (OVERALL)
 - 1: FLASH GOLD (OVERALL)
 - 2: 15 u" GOLD
 - 3: 30 u" GOLD
- UNDER PLATING NICKEL 50 μ" THICKNESS MIN

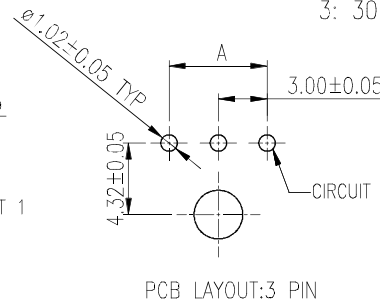
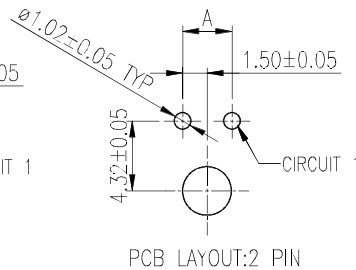
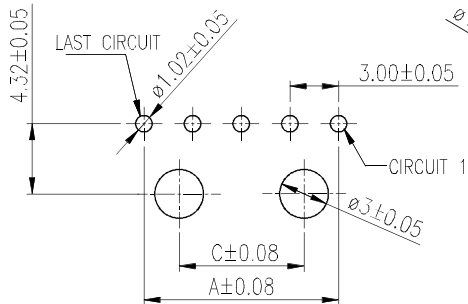

| | | | |
|-------|------|-------|------|
| 28.70 | 33.0 | 39.65 | 12 |
| 25.70 | 30.0 | 36.65 | 11 |
| 22.70 | 27.0 | 33.65 | 10 |
| 19.70 | 24.0 | 30.65 | 09 |
| 16.70 | 21.0 | 27.65 | 08 |
| 13.70 | 18.0 | 24.65 | 07 |
| 10.70 | 15.0 | 21.65 | 06 |
| 7.70 | 12.0 | 18.65 | 05 |
| 4.70 | 9.0 | 15.65 | 04 |
| NA | 6.0 | 12.65 | 03 |
| NA | 3.0 | 9.65 | 02 |
| C | A | B | POS. |

PCB LAYOUT:COMPONENT SIDE
RECOMMENDED PCB THICKNESS:1.57
4-12 CIRCUIT HEADERS

| TOLERANCE | APPROVALS | DATE | TITLE | | PART No. | |
|----------------------------------------------|-----------------------|---------------------|----------------------------------------------------------------|--|-----------------|-------------------------|
| X. X.X ±0.30 X.XX ±0.20 X.XXX ±0.10 | DRAWN Debby Hung | 02/02/2015 | G88MP SERIES MICRO POWER PLUS 3.0 PITCH S/R R/A DIP TYPE | | G88MPBXX0X2XXEU | |
| ANGULAR ±1° | CHECKED Roger Tsai | 02/02/2015 | UNIT mm | | SIZE A3 | DWG No. G88MPBXX0X2XXEU |
| UNLESS OTHERWISE SPECIFIED | APPROVED Arron Lin | 02/02/2015 | SCALE NA | | SHEET 1 OF 5 | REV. B |
| | DWG TYPE CUST DWG | PROJECT CODE PHD | | | | |

Amphenol®

Amphenol Corporation
Amphenol Taiwan Corporation

This document is the property of Amphenol Corporation and is delivered on the express condition that it is not to be disclosed, reproduced or used, in whole or in part, for manufacture or sale by anyone other than Amphenol Corporation without its prior consent, and that no right is granted to disclose or to use any information in this document.

The marking on this product doesn't contain environmental hazardous materials per Material Specification S5-00259 for Sony GP compliant or per directive 2011/65/EU for RoHS compliant.



ORIGINAL



| REVISIONS | | | | |
|-----------|----------|-----------------------------------------------|------------|-----------|
| SYM | ECN No. | DESCRIPTION | DATE | APPROVED |
| A | NE-14096 | RELEASE TO PRODUCTION | 05/21/2014 | Arron Lin |
| B | NE-15016 | COMBINE DRAWING FOR PACKAGE AND TAIL OPTIONS. | 02/02/2015 | Arron Lin |

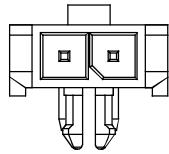

2 POS

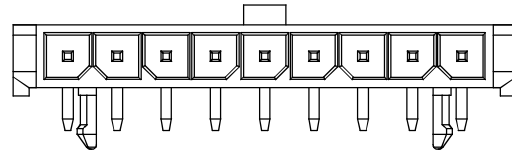

9 POS

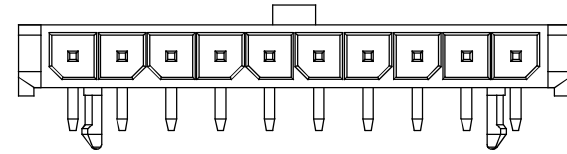

10 POS

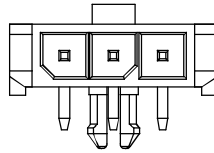

3 POS

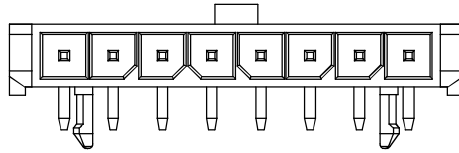

8 POS

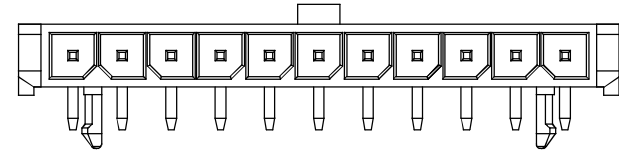

11 POS

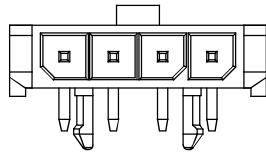

4 POS

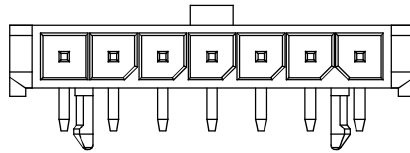

7 POS

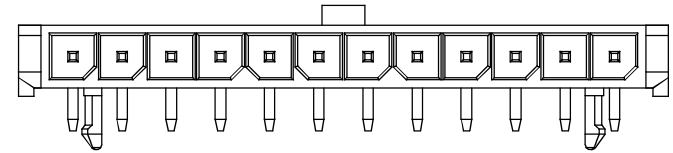

12 POS

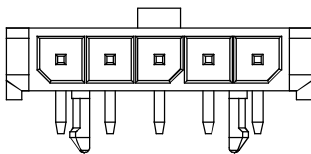

5 POS

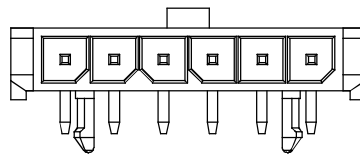

6 POS

| TOLERANCE | APPROVALS | DATE | TITLE | | | Amphenol® | | |
|----------------------------------------------|-----------------------|---------------------|----------------------------------------------------------------|-----------------|----------------------------|-----------------------------------------------------|-----------------------------|--|
| X. X.X ±0.30 X.XX ±0.20 X.XXX ±0.10 | DRAWN Debby Hung | 02/02/2015 | G88MP SERIES MICRO POWER PLUS 3.0 PITCH S/R R/A DIP TYPE | | | Amphenol Corporation Amphenol Taiwan Corporation | | |
| | CHECKED Roger Tsai | 02/02/2015 | | | | | | |
| | APPROVED Arron Lin | 02/02/2015 | | | | | | |
| ANGULAR ±1° | DWG TYPE CUST DWG | PROJECT CODE PHD | | | UNIT mm | SIZE A3 | PART No. G88MPBXX0X2XXEU | |
| UNLESS OTHERWISE SPECIFIED | | | SCALE NA | SHEET 2 OF 5 | DWG No. G88MPBXX0X2XXEU | REV. B | | |

This document is the property of Amphenol Corporation and is delivered on the express condition that it is not to be disclosed, reproduced or used, in whole or in part, for manufacture or sale by anyone other than Amphenol Corporation without its prior consent, and that no right is granted to disclose or to use any information in this document.

The marking on this product doesn't contain environmental hazardous materials per Material Specification SS-00259 for Sony GP compliant or per directive 2011/65/EU for RoHS compliant.



ORIGINAL



| REVISIONS | | | | |
|-----------|----------|-----------------------------------------------|------------|-----------|
| SYM | ECN No. | DESCRIPTION | DATE | APPROVED |
| A | NE-14096 | RELEASE TO PRODUCTION | 05/21/2014 | Arron Lin |
| B | NE-15016 | COMBINE DRAWING FOR PACKAGE AND TAIL OPTIONS. | 02/02/2015 | Arron Lin |

| POS. | BOARD-MOUNT P/N | CABLE HOUSING P/N | CABLE TERMINAL P/N | AWG NO. | PLATING OPTIONS |
|------|-----------------|-------------------|--------------------|-----------|------------------------------|
| 02 | G88MPB020X2XEU | G88MPH0221CEU | G88MPCX232CEU | AWG#16~18 | 0: TIN 100u" ; 1: FLASH GOLD |
| | | | G88MPCX332CEU | AWG#20~30 | 2: 15u" GOLD ; 3: 30u" GOLD |
| 03 | G88MPB030X2XEU | G88MPH0321CEU | G88MPCX232CEU | AWG#16~18 | 0: TIN 100u" ; 1: FLASH GOLD |
| | | | G88MPCX332CEU | AWG#20~30 | 2: 15u" GOLD ; 3: 30u" GOLD |
| 04 | G88MPB040X2XEU | G88MPH0421CEU | G88MPCX232CEU | AWG#16~18 | 0: TIN 100u" ; 1: FLASH GOLD |
| | | | G88MPCX332CEU | AWG#20~30 | 2: 15u" GOLD ; 3: 30u" GOLD |
| 05 | G88MPB050X2XEU | G88MPH0521CEU | G88MPCX232CEU | AWG#16~18 | 0: TIN 100u" ; 1: FLASH GOLD |
| | | | G88MPCX332CEU | AWG#20~30 | 2: 15u" GOLD ; 3: 30u" GOLD |
| 06 | G88MPB060X2XEU | G88MPH0621CEU | G88MPCX232CEU | AWG#16~18 | 0: TIN 100u" ; 1: FLASH GOLD |
| | | | G88MPCX332CEU | AWG#20~30 | 2: 15u" GOLD ; 3: 30u" GOLD |
| 07 | G88MPB070X2XEU | G88MPH0721EU | G88MPCX232CEU | AWG#16~18 | 0: TIN 100u" ; 1: FLASH GOLD |
| | | | G88MPCX332CEU | AWG#20~30 | 2: 15u" GOLD ; 3: 30u" GOLD |
| 08 | G88MPB080X2XEU | G88MPH0821CEU | G88MPCX232CEU | AWG#16~18 | 0: TIN 100u" ; 1: FLASH GOLD |
| | | | G88MPCX332CEU | AWG#20~30 | 2: 15u" GOLD ; 3: 30u" GOLD |
| 09 | G88MPB090X2XEU | G88MPH0921CEU | G88MPCX232CEU | AWG#16~18 | 0: TIN 100u" ; 1: FLASH GOLD |
| | | | G88MPCX332CEU | AWG#20~30 | 2: 15u" GOLD ; 3: 30u" GOLD |
| 10 | G88MPB100X2XEU | G88MPH1021CEU | G88MPCX232CEU | AWG#16~18 | 0: TIN 100u" ; 1: FLASH GOLD |
| | | | G88MPCX332CEU | AWG#20~30 | 2: 15u" GOLD ; 3: 30u" GOLD |
| 11 | G88MPB110X2XEU | G88MPH1121CEU | G88MPCX232CEU | AWG#16~18 | 0: TIN 100u" ; 1: FLASH GOLD |
| | | | G88MPCX332CEU | AWG#20~30 | 2: 15u" GOLD ; 3: 30u" GOLD |
| 12 | G88MPB120X2XEU | G88MPH1221CEU | G88MPCX232CEU | AWG#16~18 | 0: TIN 100u" ; 1: FLASH GOLD |
| | | | G88MPCX332CEU | AWG#20~30 | 2: 15u" GOLD ; 3: 30u" GOLD |

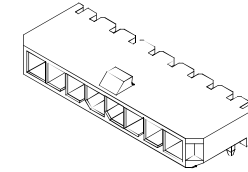

AMPHENOL BOARD-MOUNT

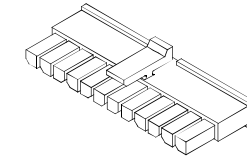

AMPHENOL CABLE HOUSING

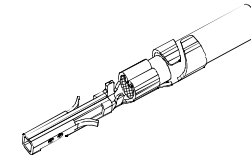

AMPHENOL CABLE TERMINAL

NOTE:
 TO ENSURE CURRENT RATING CAPABILITY,
 PLEASE ADOPT TOTAL SOLUTION.
 (G88MPH CABLE HOUSING SERIES WITH
 G88MPC CABLE TERMINAL SERIES)

| TOLERANCE | APPROVALS | DATE | TITLE | | | Amphenol® | | | |
|----------------------------------------------------------------------------------|-----------------------|---------------------|----------------------------------------------------------------|------------|-----------------------------|-----------------------------------------------------|-----------------|----------------------------|-----------|
| X. ±0.30 X.X ±0.20 X.XX ±0.10 ANGULAR ±1° UNLESS OTHERWISE SPECIFIED | DRAWN Debby Hung | 02/02/2015 | G88MP SERIES MICRO POWER PLUS 3.0 PITCH S/R R/A DIP TYPE | | | Amphenol Corporation Amphenol Taiwan Corporation | | | |
| | CHECKED Roger Tsai | 02/02/2015 | | | | | | | |
| | APPROVED Arron Lin | 02/02/2015 | | | | | | | |
| | DWG TYPE CUST DWG | PROJECT CODE PHD | UNIT mm | SIZE A3 | PAPT No. G88MPBXX0X2XXEU | SCALE NA | SHEET 3 OF 5 | DWG No. G88MPBXX0X2XXEU | REV. B |

This document is the property of Amphenol Corporation and is delivered on the express condition that it is not to be disclosed, reproduced or used, in whole or in part, for manufacture or sale by anyone other than Amphenol Corporation without its prior consent, and that no right is granted to disclose or to use any information in this document.

The marking on this product doesn't contain environmental hazardous materials per Material Specification SS-00259 for Sony GP compliant or per directive 2011/65/EU for RoHS compliant.



ORIGINAL



| REVISIONS | | | | |
|-----------|----------|-----------------------------------------------|------------|-----------|
| SYM | ECN No. | DESCRIPTION | DATE | APPROVED |
| A | NE-14096 | RELEASE TO PRODUCTION | 05/21/2014 | Arron Lin |
| B | NE-15016 | COMBINE DRAWING FOR PACKAGE AND TAIL OPTIONS. | 02/02/2015 | Arron Lin |

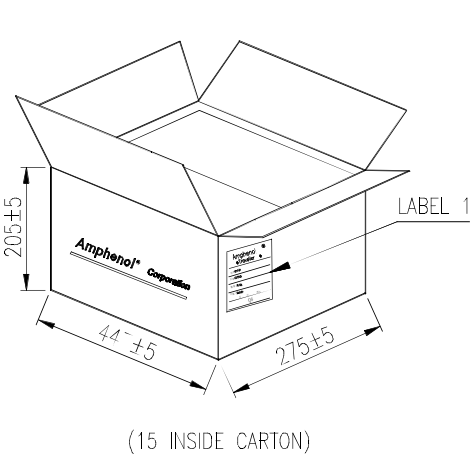
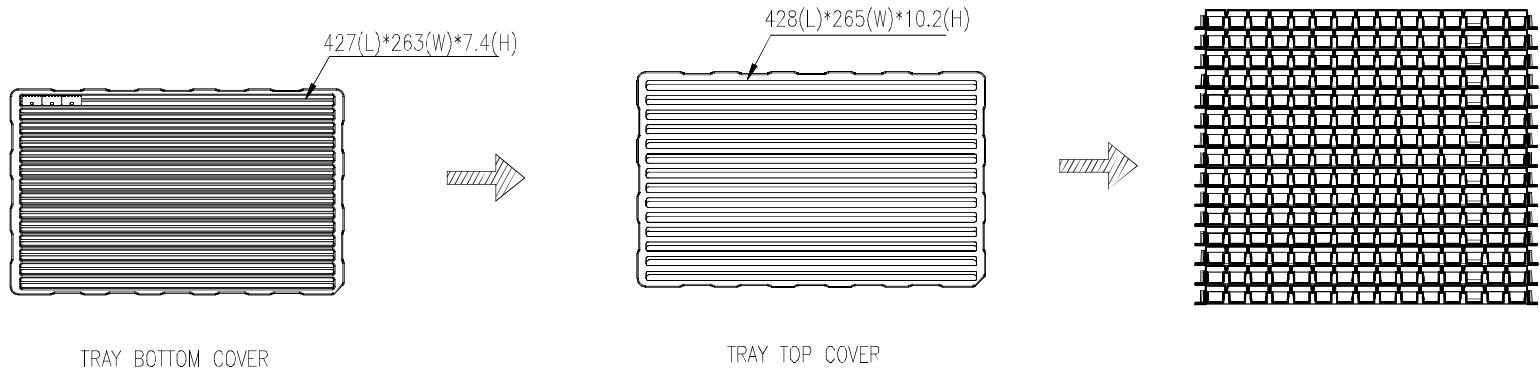

| POS | PCS/TRAY | PCS/CARTON |
|-----|----------|------------|
| 02 | 574 | 8610 |
| 03 | 434 | 6510 |
| 04 | 350 | 5250 |
| 05 | 294 | 4410 |
| 06 | 252 | 3780 |
| 07 | 224 | 3360 |
| 08 | 196 | 2940 |
| 09 | 182 | 2730 |
| 10 | 154 | 2310 |
| 11 | 140 | 2100 |
| 12 | 140 | 2100 |

| TOLERANCE | APPROVALS | DATE | TITLE | | UNIT | | SIZE | | PART No. | |
|----------------------------|--------------------|------------|----------------------------------------------------------------|--|------------------|--|--------------|--|-------------------------|--|
| X. ±0.30 | DRAWN Debby Hung | 02/02/2015 | G88MP SERIES MICRO POWER PLUS 3.0 PITCH S/R R/A DIP TYPE | | mm | | A3 | | G88MPBXX0X2XXEU | |
| >.XX ±0.20 | CHECKED Roger Tsai | 02/02/2015 | | | SCALE NA | | SHEET 4 OF 5 | | DWG No. G88MPBXX0X2XXEU | |
| >.XXX ±0.10 | APPROVED Arron Lin | 02/02/2015 | | | PROJECT CODE PHD | | REV. B | | | |
| ANGULAR ±1° | DWG TYPE CUST DWG | | | | | | | | | |
| UNLESS OTHERWISE SPECIFIED | | | | | | | | | | |

Amphenol®
Amphenol Corporation
Amphenol Taiwan Corporation

This document is the property of Amphenol Corporation and is delivered on the express condition that it is not to be disclosed, reproduced or used, in whole or in part, for manufacture or sale by anyone other than Amphenol Corporation without its prior consent, and that no right is granted to disclose or to use any information in this document.

The marking on this product doesn't contain environmental hazardous materials per Material Specification SS-00259 for Sony GP compliant or per directive 2011/65/EU for RoHS compliant.



ORIGINAL



| REVISIONS | | | | |
|-----------|----------|-----------------------------------------------|------------|-----------|
| SYM | ECN No. | DESCRIPTION | DATE | APPROVED |
| A | NE-14096 | RELEASE TO PRODUCTION | 05/21/2014 | Arron Lin |
| B | NE-15016 | COMBINE DRAWING FOR PACKAGE AND TAIL OPTIONS. | 02/02/2015 | Arron Lin |

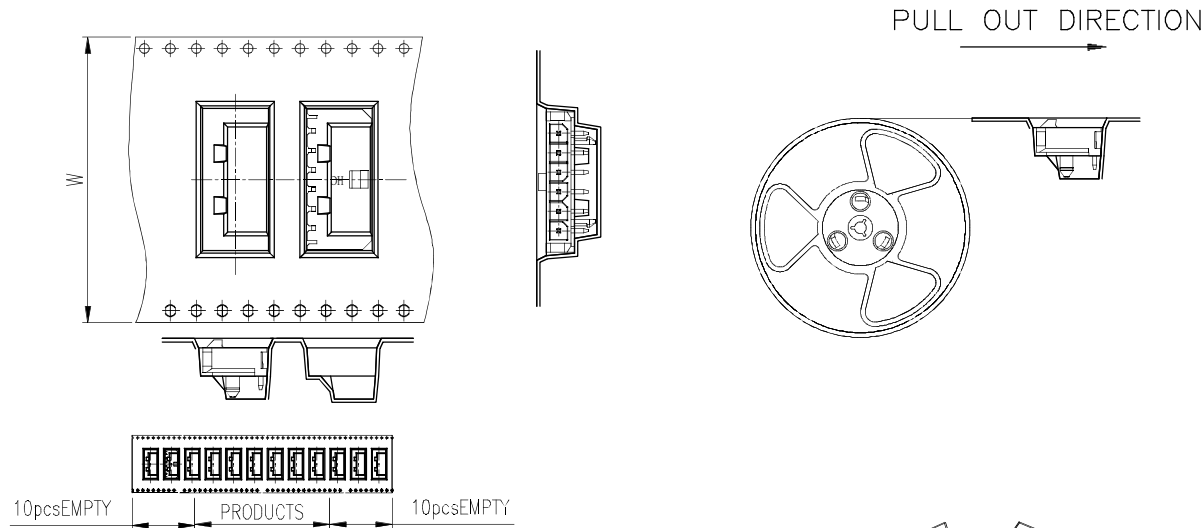

| POS | W | PCS/REEL | PCS/CARTON |
|-----|----|----------|------------|
| 12 | 56 | 400 | 1200 |
| 11 | 56 | 400 | 1200 |
| 10 | 56 | 400 | 1200 |
| 09 | 56 | 400 | 1200 |
| 08 | 44 | 400 | 1600 |
| 07 | 44 | 400 | 1600 |
| 06 | 44 | 400 | 1600 |
| 05 | 32 | 400 | 2000 |
| 04 | 32 | 400 | 2000 |
| 03 | 24 | 400 | 2800 |
| 02 | 24 | 400 | 2800 |

| |
|-----------------------------------------|
| P/N : |
| Q'TY : XX |
| P/O : XXX-XXXXXX-XXX |
| DATE : XX / XX / XXXX MM / DD / YYYY |
| G.W : XX KG RoHS |
| Amphenol Taiwan Corporation |

LABEL1 & LABEL2

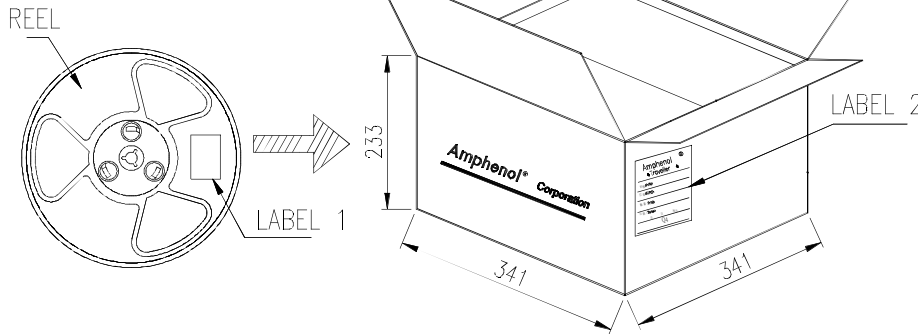

| TOLERANCE | APPROVALS | DATE | TITLE | | | Amphenol® | | |
|----------------------------------------------|-----------------------|---------------------|----------------------------------------------------------------|-------------|-----------------|-----------------------------------------------------|-----------|--|
| X. X.X ±0.30 X.XX ±0.20 X.XXX ±0.10 | DRAWN Debby Hung | 02/02/2015 | G88MP SERIES MICRO POWER PLUS 3.0 PITCH S/R R/A DIP TYPE | | | Amphenol Corporation Amphenol Taiwan Corporation | | |
| ANGULAR ±1° | CHECKED Roger Tsai | 02/02/2015 | | UNIT mm | SIZE A3 | PAPT No. G88MPBXX0X2XXEU | | |
| UNLESS OTHERWISE SPECIFIED | APPROVED Arron Lin | 02/02/2015 | | SCALE NA | SHEET 5 OF 5 | DWG No. G88MPBXX0X2XXEU | REV. B | |
| | DWG TYPE CUST DWG | PROJECT CODE PHD | | | | | | |