

RECOMMENDED PANEL LAYOUT

$a \text{---} \text{---} b (+)$

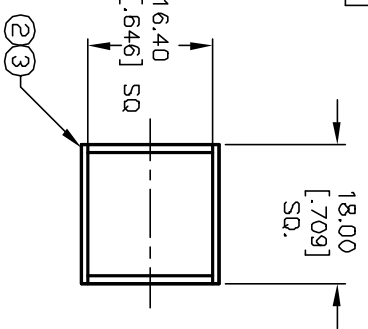

CONTACT CONFIGURATION

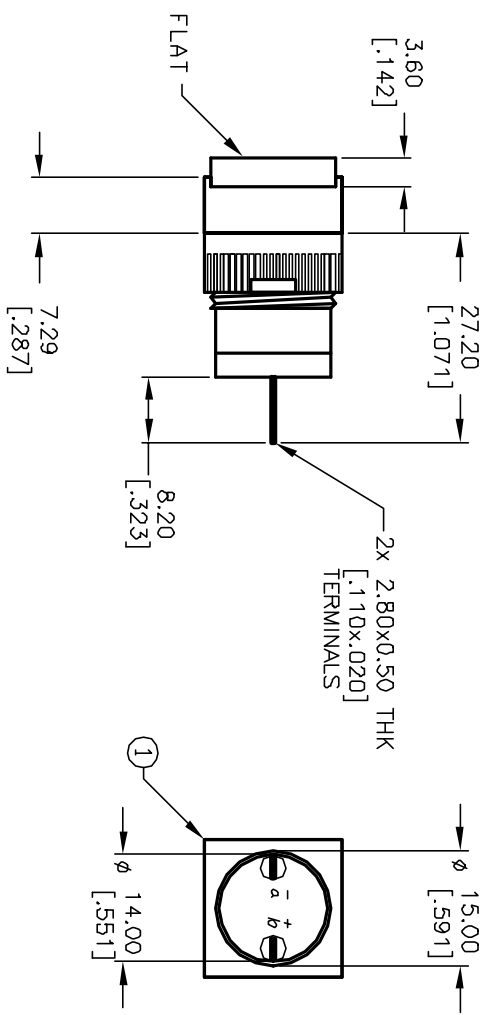

Item	Qty.	Dwg. No.	Part No.
1	1	F040002	L16 PLS10
2	1	F050424	50-004-24 YEL L.E.D.
3	1	F050316	50-003-16 YEL LENS TRANSPARENT

- NOTES:
1. ALL DIMENSIONS IN MM [INCH]
  2. GENERAL TOLERANCE: X.X=±0.4  
X.XX=±0.25
  3. TERM. NOS. FOR REFERENCE ONLY.
  4. RATING: 5A @250V AC  
8A @125V AC
  5. LAMP VOLTAGE: 24V DC LED
  6. MECHANICAL LIFETIME: >2 MILLION OPERATIONS
  7. CONTACT MATERIAL: COPPER ALLOY W/SILVER PLATING

REV.	ECN No.	DESCRIPTION	DATE	CHKD
A	12439	RELEASED FOR PRODUCTION	9/20/02	CB

TITLE		L16 PL S10 K YEL YEL	
SCALE	DATE	DR	DWG
1:1	9/20/02	CB	XF0506P
THE INFORMATION CONTAINED IN THIS DOCUMENT IS PROPRIETARY TO E-SWITCH AND IS NOT TO BE COPIED OR TRANSFERRED		REV	A

