

Directive 2002/95/EC
"RoHS"
Compliant

- NOTES:
- INSULATORS: PBT GF UL 94 V-0, GREY
 - CONTACTS: COPPER ALLOY
PLATING: GOLD over NICKEL
50 MATING CYLES
 - CONNECTOR IS PART MARKED: 122A11129X CONEC ABC

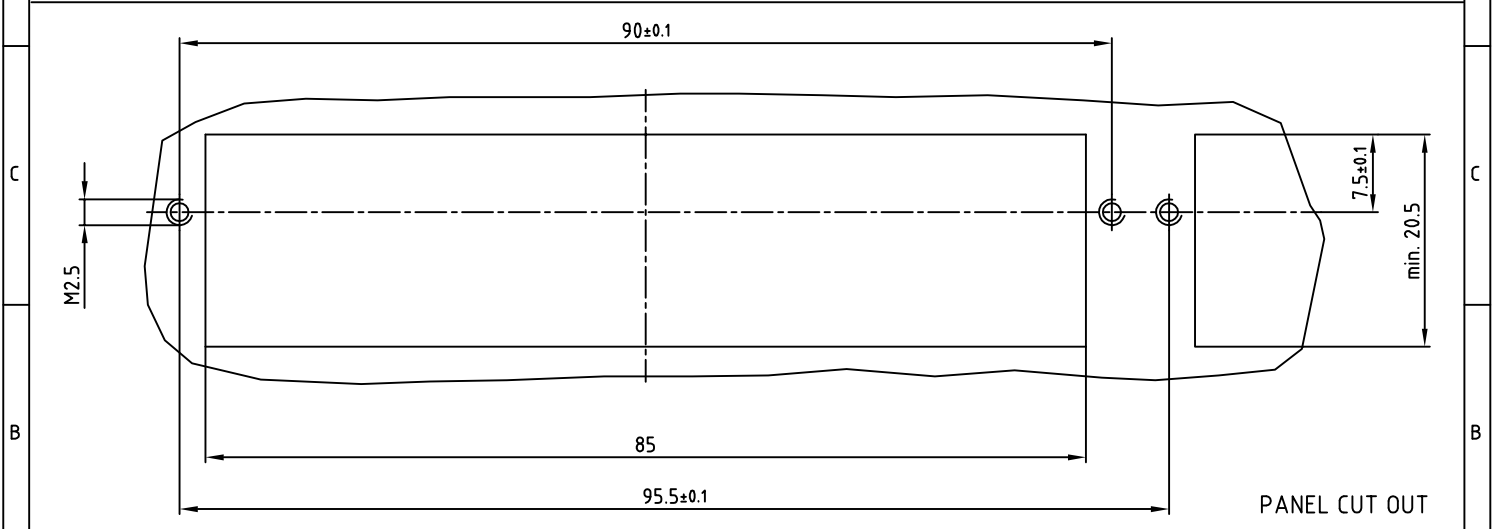

APPROVAL # FREIGABE # DEBLOCAGE # AUTORIZACION # APPROVAL

CUSTOMER APPROVAL DATE:

NAME: TITLE:

COMPANY NAME:

APPROVAL # FREIGABE # DEBLOCAGE # AUTORIZACION # APPROVAL

THIS DRAWING MAY NOT BE COPIED OR REPRODUCED IN ANY WAY, AND MAY NOT BE PASSED ON TO A THIRD PARTY, WITHOUT WRITTEN PERMISSION. OWNERSHIP AND COPYRIGHT OF CONEC GmbH DO NOT ALTER CAD DRAWING BY HAND

rev.	description	date	name
a	Origin		

tolerance	\varnothing dim. in mm	scale:	2:1
		material:	SEE NOTES
2007	date	name	title:
drawn	24.04.	Lehmenkühler	FEMALE CONNECTOR TYPE "G"
appd.	24.04.	Mickenbecker	64pos. WIRE WRAP, 1x1mm
norm	DIN EN 60603-2		
d-old			
dwg no:		AutoCAD 2006	DIN-A
12K1A465			3
part no:		122A11129X	
		sh: 1/1	

